

Installation Guide Connection System

! Always apply sealing tape to ceiling opening prior to installation of attic hatch!
Watch ceiling construction! (see below)

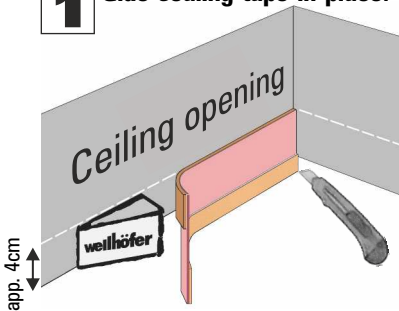

1 Glue sealing tape in place:



Cut off in corners and re-apply.

3 Push in insulation braid:

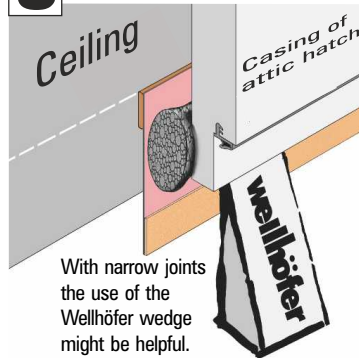

With narrow joints the use of the Wellhöfer wedge might be helpful.

Cut off in corners and re-apply. For close connection upset joints in the corners.



For attic stairs with fire protection FS:
 Push in hardly flammable fire protection braid instead of insulating braid!
 (Installation Guide Attic Stairs FS)

4 Close the gap:

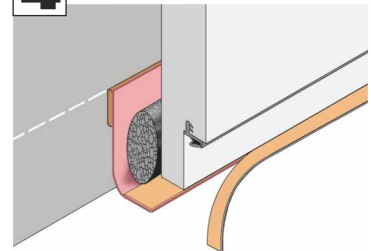

If required, cut projecting tape flush with joint angles.

Glue sealing tape to lining bar all over.

2 Install attic hatch
 (Installation Guide Attic Stairs / Access Hatch)

5 Install cover profiles
 (Installation Guide Cover Profiles)

Full effect is gained only if the ceiling connection system has been implemented as described above.



Correct air-tight connection:

! Glue **Wellhöfer sealing tape** tightly and securely onto the **on-site air-tight barrier!**
Watch ceiling construction / thermal bridges / fire protection regulations and where necessary fill additional insulation into gap on-site.



Concrete ceiling

Suspended ceiling

Wodden beam ceiling with counter battens

