

# Wellhöfer attic stairs



## CLIMATE NEUTRAL PRODUCTS

certified by [fokus-zukunft.com/10014](https://fokus-zukunft.com/10014)  
Currently unavoidable emissions compensated  
by climate protection certificates

## LOW-EMISSION PRODUCTS

according to the criteria of



**SENTINEL HAUS  
INSTITUT**

**wellhöfer**  
**TREPPEN AUS WÜRZBURG**  
Made in Germany

So far German only.  
Sorry for the inconvenience.

**Use configurator:**  
[www.massbox.de](http://www.massbox.de)

Please use internet browser for translation



# Wellhöfer attic stairs range

GutHolz, AluDrei, StahlBlau and Liliput as standard with **thermal protection WS3D** (U-value 0.80, air-tightness Class 4, connection system)

				
<b>StirnBrett</b>	<b>GutHolz</b>	<b>AluDrei</b>	<b>StahlBlau</b>	<b>LiliPut</b>
Concertina loft ladder with backboard	<b>Always the right choice</b> 3-section, wood, step depth 9 cm	<b>For highest resilience</b> 3-section, alu, step depth 11 cm	<b>For special requirements</b> 3-section, steel, step depth 11 cm	<b>Comfort within little space</b> Concertina, alu, step depth 11 cm

<b>Standard sizes</b>						
Ceiling opening dimensions (Length x Width)	110 x 60	120 x 60	130 x 60	140 x 60	90 x 60	100 x 60
	110 x 70	120 x 70	130 x 70	140 x 70	90 x 70	100 x 70
Casing height (ceiling thickness)	25					
<b>Custom-made</b> Divergent dimensions with thermal protection WS4D/WSPH, fire protection and flat roof exit.						
Ceiling opening dimensions (Length x Width)	min. 100 x 50			min. 105 x 60		min. 75* x 50
	max. 160 x 100			max. 160 x 100		max. 160 x 100
Casing height (ceiling thickness)	17 - 90					
<b>Floor-to-ceiling heights</b> Floor-to-ceiling height, type of stairs and additional features determine the minimum length of the ceiling opening!						
Floor-to-ceiling height (min. - max.)	197 - 360			237 - 314		190 - 410**

Dimensions are construction site dimensions in centimetres. Divergent dimensions may apply in combination with additional features.  
Ceiling opening dimensions = order dimensions. For installation space, factory-made casing dimensions are 1.5 cm (length/width) smaller.  
\* We recommend a minimum length of at least 90 cm for the ceiling opening, otherwise the clearance will be very narrow!  
\*\* Floor-to-ceiling heights 320 cm and higher always require the comfort operation for the concertina attic stairs Liliput.

## Additional features

Always order together with the attic stairs. Guardrail and handrail retrofittable.

<b>Safety</b> Features for all requirements and demands.				
Guardrail	Tested stability, required by building regulations			
Handrail	Handrail wood GH/SB	AluDrei-Handrail wood	Handrail wood GH/SB	Handrail telescope
Lock	with round cylinder / with profile cylinder / prepared for profile cylinder			
<b>Energy conservation</b> Save more energy with better thermal protection				
Thermal protection WS4D	Double insulation + sealing + connection system. Component tested U-value 0.58			
Thermal protection WSPH	Certified Passive House component for cold climate. Minimized thermal bridges. U <sub>e</sub> 0.48			
<b>Optic &amp; comfort</b> Flush with the ceiling for perfect optics. Increased ease of use.				
Ceiling-flush	Additional lower cover with even surface, white ring eye, plastering profiles, easy-installation system (detachable hatch door)			
Wide cover profiles	55 mm wide, in combination with custom-made attic stairs, as standard with WSPH			
Operation stairs				Comfort operation
<b>Fire protection</b> Incl. certified ceiling connection system for safe installation				
Fire protection FS30	Fire resistance 30 minutes from below			
Fire protection FS30 2S	Fire resistance 30 minutes from top and bottom			
Fire protection FS90 2S	Fire resistance 90 minutes from top and bottom			
<b>Flat roof</b> Safe access to the flat roof				
Flat roof exit	Rear ventilation. One-hand operation. Available for all types of attic stairs and additional features.			

Attic stairs GutHolz

# GutHolz



Photo shows attic stairs GutHolz with thermal protection WS4D and handrail



**CLIMATE NEUTRAL PRODUCT**

certified by fokus-zukunft.com/10014  
Currently unavoidable emissions compensated by climate protection certificates

**LOW-EMISSION PRODUCT**  
according to the criteria of



**SENTINEL HAUS  
INSTITUT**

# Always the right choice

Reliable 3-section wooden attic stairs

# GutHolz

Attic stairs GutHolz

- **9 cm deep, corrugated hardwood steps**
- **Stair width up to 40 cm**
- **Solid wood stringers and hardwood treads in stable dovetail joint**
- **EN-compliant step distance without sawing off**  
When ordered with the actual floor-to-ceiling height, the fitting stairs is supplied
- **Abrasion-resistant 2-component feet covers**  
Optimum stability and perfect floor protection

## Standard advantages

- **Low-emission and sustainable product**  
Tested and certified by Sentinel Haus
- **Certified climate neutral product**  
Currently unavoidable emissions compensated by climate protection certificates
- **Suitable for all roof constructions**  
From ventilated to cold roof
- **With thermal protection WS3D**  
Tested insulation U-value 0.80, air-tightness Class 4, climate stability Class 3
- **15 years manufacturer's guarantee on function**



## Dimensions in centimetres

Standard sizes				
Ceiling opening dimensions (Length x Width)	110 x 60	120 x 60	130 x 60	140 x 60
	110 x 70	120 x 70	130 x 70	140 x 70
Ceiling thickness = casing height	25			
Custom-made				
Ceiling opening dimensions (Length x Width)	min. 100 x 50 max. 160 x 100			
Ceiling thickness = casing height	17 - 90			
Floor-to-ceiling heights and additional features determine minimum length of the ceiling opening				
Floor-to-ceiling height (min. - max.)	197 - 360			

Order with all 4 dimensions

Quick and error-free to the fitting attic stairs.

Use the configurator:

[www.massbox.de](http://www.massbox.de)



*So far German only. Sorry for the inconvenience. Please use internet browser for translation.*

Dimensions are construction site dimensions for attic stairs GutHolz with thermal protection WS3D. Divergent dimensions may apply in combination with additional features. Ceiling opening dimensions = order dimensions. For installation space, factory-made casing dimensions are 1.5 cm (length/width) smaller.

## Additional features

Energy conservation	Safety	Optics	Fire protection
<b>Air-tightness Class 4, a-value 0.01, climate-stability Class 3.</b> <ul style="list-style-type: none"> <li>■ <b>Thermal protection WS4D</b> U-value 0.58 Double insulation+sealing+connection system</li> <li>■ <b>Thermal protection WSPH</b> Certified Passive House component for cold climate incl. PH-connection system</li> </ul>	<ul style="list-style-type: none"> <li>■ <b>Guardrail</b> Required by building regulations</li> <li>■ <b>Handrail</b> Providing hold and safe grip</li> <li>■ <b>Lock</b></li> </ul>	<ul style="list-style-type: none"> <li>■ <b>Ceiling-flush version</b> Even with the ceiling</li> <li>■ <b>Wide cover profiles</b> 55 mm wide, for custom-made</li> </ul>	<b>Always with connection system.</b> <ul style="list-style-type: none"> <li>■ <b>Fire protection FS30</b> 30 min. from below</li> <li>■ <b>Fire protection FS30 2S</b> 30 min. from top and bottom</li> <li>■ <b>Fire protection FS90 2S</b> 90 min. from top and bottom</li> </ul>
<b>Flat roof exit</b> Available for all types of stairs and all variants of thermal and fire protection			

Attic stairs AluDrei

# AluDrei



Photo shows attic stairs AluDrei with thermal protection WS4D and handrail



**CLIMATE NEUTRAL PRODUCT**

certified by fokus-zukunft.com/10014  
Currently unavoidable emissions compensated by climate protection certificates

**LOW-EMISSION PRODUCT**  
according to the criteria of



**SENTINEL HAUS  
INSTITUT**

# For highest resilience

Stable and lightweight 3-section aluminium attic stairs

# AluDrei

Attic stairs AluDrei

- **Overload method tested for 200 kg loading**
- **11 cm deep, corrugated steps**
- **Stair width up to 40 cm**
- **Stringers made of aluminium profile with rounded edges**

## Standard advantages

- **Low-emission and sustainable product**  
Tested and certified by Sentinel Haus
- **Certified climate neutral product**  
Currently unavoidable emissions compensated by climate protection certificates
- **Suitable for all roof constructions**  
From ventilated to cold roof
- **With thermal protection WS3D**  
Tested insulation U-value 0.80, air-tightness Class 4, climate stability Class 3
- **15 years manufacturer's guarantee on function**



## Dimensions in centimetres

Standard sizes				
Ceiling opening dimensions (Length x Width)	110 x 60	120 x 60	130 x 60	140 x 60
	110 x 70	120 x 70	130 x 70	140 x 70
Ceiling thickness = casing height	25			
Custom-made				
Ceiling opening dimensions (Length x Width)	min. 100 x 50 max. 160 x 100			
Ceiling thickness = casing height	17 - 90			
Floor-to-ceiling heights and additional features determine minimum length of the ceiling opening				
Floor-to-ceiling height (min. - max.)	197 - 360			

Order with all 4 dimensions

Quick and error-free to the fitting attic stairs.

Use the configurator:

[www.massbox.de](http://www.massbox.de)

So far German only. Sorry for the inconvenience. Please use internet browser for translation.

Dimensions are construction site dimensions for attic stairs AluDrei with thermal protection WS3D. Divergent dimensions may apply in combination with additional features. Ceiling opening dimensions = order dimensions. For installation space, factory-made casing dimensions are 1.5 cm (length/width) smaller.

## Additional features

Energy conservation	Safety	Optics	Fire protection
<b>Air-tightness Class 4, a-value 0.01, climate-stability Class 3.</b> <ul style="list-style-type: none"> <li>■ Thermal protection <b>WS4D</b> U-value 0.58 Double insulation+sealing+connection system</li> <li>■ Thermal protection <b>WSPH</b> Certified Passive House component for cold climate incl. PH-connection system</li> </ul>	<ul style="list-style-type: none"> <li>■ <b>Guardrail</b> Required by building regulations</li> <li>■ <b>AluDrei-handrail</b> wood Providing hold and safe grip</li> <li>■ <b>Lock</b></li> </ul>	<ul style="list-style-type: none"> <li>■ <b>Ceiling-flush version</b> Even with the ceiling</li> <li>■ <b>Wide cover profiles</b> 55 mm wide, for custom-made</li> </ul>	<b>Always with connection system.</b> <ul style="list-style-type: none"> <li>■ Fire protection <b>FS30</b> 30 min. from below</li> <li>■ Fire protection <b>FS30 2S</b> 30 min. from top and bottom</li> <li>■ Fire protection <b>FS90 2S</b> 90 min. from top and bottom</li> </ul>
<b>Flat roof exit</b> Available for all types of stairs and all variants of thermal and fire protection			

# StahlBlau



**CLIMATE NEUTRAL PRODUCT**

certified by fokus-zukunft.com/10014  
Currently unavoidable emissions compensated by climate protection certificates

**LOW-EMISSION PRODUCT**  
according to the criteria of



**SENTINEL HAUS  
INSTITUT**

# For special requirements

Robust 3-section steel attic stairs

# StahlBlau

- 11 cm deep steps with non-slip mats
- Stair width 40 cm
- Wear- and corrosion-resistant surface  
Double lacquered
- Very stable design

## Standard advantages

- **Low-emission and sustainable product**  
Tested and certified by Sentinel Haus
- **Certified climate neutral product**  
Currently unavoidable emissions compensated by climate protection certificates
- **Suitable for all roof constructions**  
From ventilated to cold roof
- **With thermal protection WS3D**  
Tested insulation U-value 0.80, air-tightness Class 4, climate stability Class 3
- **15 years manufacturer's guarantee on function**



## Dimensions in centimetres

Standard sizes				
Ceiling opening dimensions (Length x Width)	110 x 60	120 x 60	130 x 60	140 x 60
	110 x 70	120 x 70	130 x 70	140 x 70
Ceiling thickness = casing height	25			
Custom-made				
Ceiling opening dimensions (Length x Width)	min. 105 x 60 max. 160 x 100			
Ceiling thickness = casing height	17 - 90			
<b>Floor-to-ceiling heights</b> and additional features determine minimum length of the ceiling opening				
Floor-to-ceiling height (min. - max.)	237 - 314			

**Order with all 4 dimensions**  
Quick and error-free to the fitting attic stairs.  
Use the configurator:  
[www.massbox.de](http://www.massbox.de)



*So far German only. Sorry for the inconvenience. Please use internet browser for translation.*

Dimensions are construction site dimensions for attic stairs StahlBlau with thermal protection WS3D. Divergent dimensions may apply in combination with additional features. Ceiling opening dimensions = order dimensions. For installation space, factory-made casing dimensions are 1.5 cm (length/width) smaller.

## Additional features

Energy conservation	Safety	Optics	Fire protection
<b>Air-tightness Class 4, a-value 0.01, climate-stability Class 3.</b> <ul style="list-style-type: none"> <li>■ Thermal protection <b>WS4D</b> U-value 0.58 Double insulation+sealing+connection system</li> <li>■ Thermal protection <b>WSPH</b> Certified Passive House component for cold climate incl. PH-connection system</li> </ul>	<ul style="list-style-type: none"> <li>■ <b>Guardrail</b> Required by building regulations</li> <li>■ <b>Handrail</b> Providing hold and safe grip</li> <li>■ <b>Lock</b></li> </ul>	<ul style="list-style-type: none"> <li>■ <b>Ceiling-flush version</b> Even with the ceiling</li> <li>■ <b>Wide cover profiles</b> 55 mm wide, for custom-made</li> </ul>	<b>Always with connection system.</b> <ul style="list-style-type: none"> <li>■ Fire protection <b>FS30</b> 30 min. from below</li> <li>■ Fire protection <b>FS30 2S</b> 30 min. from top and bottom</li> <li>■ Fire protection <b>FS90 2S</b> 90 min. from top and bottom</li> </ul>
<b>Flat roof exit</b> Available for all types of stairs and all variants of thermal and fire protection			

# LiliPut



## CLIMATE NEUTRAL PRODUCT

certified by fokus-zukunft.com/10014  
Currently unavoidable emissions compensated by climate protection certificates

## LOW-EMISSION PRODUCT

according to the criteria of



**SENTINEL HAUS  
INSTITUT**

# Comfort within little space

High-quality aluminium concertina attic stairs

# LiliPut

- 11 cm deep, corrugated steps
- Stair width up to 40 cm
- Elegant design with aluminium profiles
- **Comfort operation stair section**  
For floor-to-ceiling heights 320 - 410 cm always included, up to 319 cm optional



Comfort operation stair section

## Standard advantages

- **Low-emission and sustainable product**  
Tested and certified by Sentinel Haus
- **Certified climate neutral product**  
Currently unavoidable emissions compensated by climate protection certificates
- **Suitable for all roof constructions**  
From ventilated to cold roof
- **With thermal protection WS3D**  
Tested insulation U-value 0.80, air-tightness Class 4, climate stability Class 3
- **15 years manufacturer's guarantee on function**



## Dimensions in centimetres

Standard sizes	
Ceiling opening dimensions (Length x Width)	90 x 60    100 x 60 90 x 70    100 x 70
Ceiling thickness = casing height	25
Custom-made	
Ceiling opening dimensions (Length x Width)	min. 75* x 50 max. 160 x 100
Ceiling thickness = casing height	17 - 90
Floor-to-ceiling heights and additional features determine minimum length of the ceiling opening	
Floor-to-ceiling height (min. - max.)	190 - 410**

Order with all 4 dimensions



Quick and error-free to the fitting attic stairs.  
Use the configurator:  
[www.massbox.de](http://www.massbox.de)

*So far German only. Sorry for the inconvenience. Please use internet browser for translation.*

Dimensions are construction site dimensions for attic stairs LiliPut with thermal protection WS3D. Divergent dimensions may apply in combination with additional features. Ceiling opening dimensions = order dimensions. For installation space, factory-made casing dimensions are 1.5 cm (length/width) smaller.

\* We recommend a minimum length of at least 90 cm for the ceiling opening, otherwise the clearance will be very narrow!

\*\* Floor-to-ceiling heights 320 cm and higher always require the comfort operation for the stair section.

## Additional features

Energy conservation	Safety	Optics and comfort	Fire protection
<b>Air-tightness Class 4, a-value 0.01, climate-stability Class 3.</b> <ul style="list-style-type: none"> <li>■ Thermal protection <b>WS4D</b> U-value 0.58 Double insulation+sealing+connection system</li> <li>■ Thermal protection <b>WSPH</b> Certified Passive House component for cold climate incl. PH-connection system</li> </ul>	<ul style="list-style-type: none"> <li>■ <b>Guardrail</b> Required by building regulations</li> <li>■ <b>Handrail telescope</b> Providing hold and safe grip</li> <li>■ <b>Lock</b></li> </ul>	<ul style="list-style-type: none"> <li>■ <b>Ceiling-flush version</b> Even with the ceiling</li> <li>■ <b>Wide cover profiles</b> 55 mm wide, for custom-made</li> <li>■ <b>Comfort operation</b> For the stair section</li> </ul>	<b>Always with connection system.</b> <ul style="list-style-type: none"> <li>■ <b>Fire protection FS30</b> 30 min. from below</li> <li>■ <b>Fire protection FS30 2S</b> 30 min. from top and bottom</li> <li>■ <b>Fire protection FS90 2S</b> 90 min. from top and bottom</li> </ul>
<b>Flat roof exit</b> Available for all types of stairs and all variants of thermal and fire protection			

# StirnBrett

# Aluminium concertina loft ladder with backboard

- 11 cm deep, corrugated steps
- Stair width 40 cm
- For ceiling openings from 80 x 60 cm

Suitable for replacing an old loft ladder, refitting an existing attic hatch or under skylight windows. The concertina loft ladder can be fixed into openings as small as 80 x 60 cm (L x W). The 11 cm deep, corrugated aluminium steps provide safety and comfort. The loft ladder is easy to operate due to its light weight (extruded aluminium).

Backboard (plywood, thickness 18 mm, 41.2 x 17.6 cm), fixing screws, holding brackets for ladder, hook for tension rod are included in the scope of delivery.

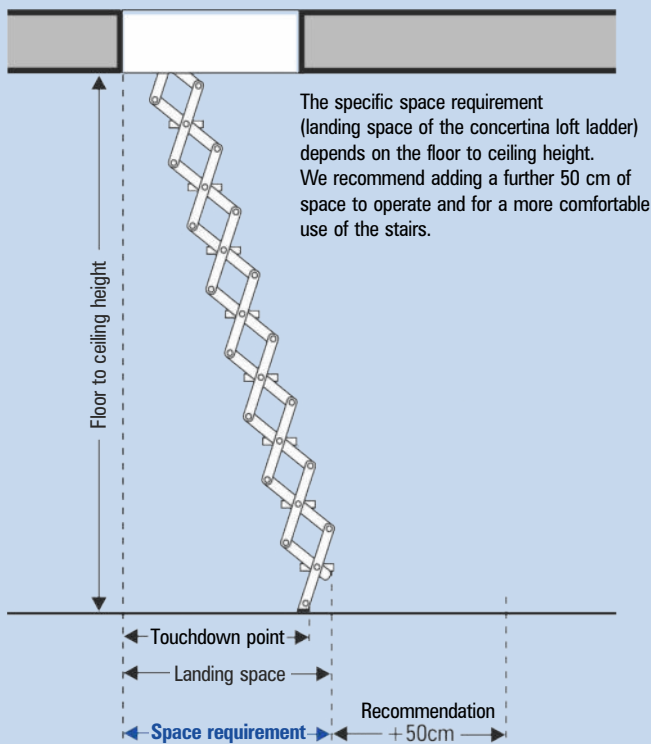

## Measurements:

Steps	Floor to ceiling height	Space requirement
9	214 - 242	91
10	243 - 269	100
11	270 - 296	108
12	297 - 320	117

Measurements in centimetres. We recommend adding a further 50 cm of space to operate and for a more comfortable use of the stairs.

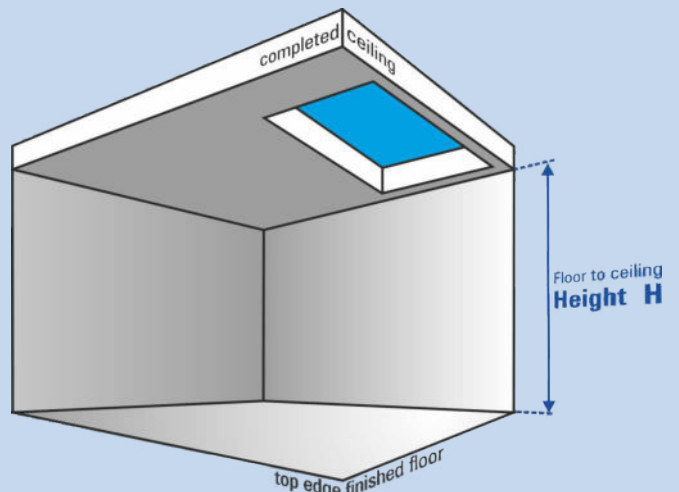

**Order dimensions = floor to ceiling height:**  
Height between finished floor and completed ceiling.



# Additional features for Wellhöfer attic stairs

Safety, comfort, optics



## Guardrail

The guardrail is **required by the building regulations** - even in owner-occupied homes. It **protects against falls** and **provides support** when entering and exiting the loft.

The Wellhöfer guardrail is **stability-tested**, is supplied with the complete fastening material and can be retrofittable.

Note: The casing height of the attic stairs must at least correspond to the ceiling thickness so that the railing height reaches the required 90 cm.



## Handrail

The EN regulations for attic stairs recommend a handrail. Handrails are optionally available for the right, left and for both sides.

A **wooden handrail** provides grip when using the 3-section attic stairs GutHolz/AluDrei/StahlBlau.

For the concertina attic stairs Liliput, an aluminium **telescopic handrail** provides safety.



## Lock

### Lock prepared for profile cylinder:

Available for all attic stairs types and features.

### Lock with profile cylinder:

Available for all attic stairs types and features.

### Lock with round cylinder:

Not available for attic stairs with double-sided fire protection (FS30 2S, FS90 2S).



## Comfort operation for Liliput stair section

The comfort operation **makes it easy to push in and pull out the concertina stair section** and **increases the stability** of the stairs.

For floor-to-ceiling heights of 320 cm and higher, every Liliput is therefore always equipped with the comfort operation. For lower floor-to-ceiling heights the comfort operation is optional.



## Ceiling-flush version

Nowadays, **visually discreet attic stairs** are often desired, without offset lids or protruding cover profiles. This modern look with a **smooth transition to the ceiling** is offered by the flush ceiling version:

Lower cover with smooth visible side from below, ring eye and sealing disc in white, pull hook coated, plastering profiles, easy-installation system for easy installation and clean plastering.



## Wide cover profiles

As an option for custom-made attic stairs 55 mm wide cover profiles are available instead of the standard 40 mm wide profiles.

The wide cover profiles also have a **rounded profile** and are **always mitred to fit**. The **plugin-system** makes installation quick and easy.

Overlap (projection on the ceiling) in relation to the order dimension of the ceiling opening:

- Standard cover profiles: 2 cm
- Wide cover profiles for custom-made attic stairs: 3.5 cm
- Wide cover profiles as standard with thermal protection WSPH: 2.5 cm

# 4-way tested thermal protection WS for attic stairs: Insulation + sealing + ceiling connection + climate class

Very good as standard:

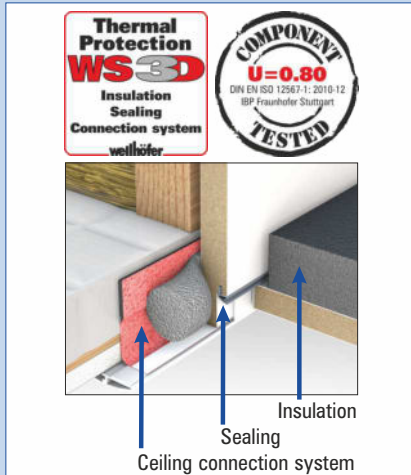

Better:



Best:



Even with standard thermal protection WS3D, Wellhöfer attic stairs are suitable for any roof construction.

## Insulation: Honest U-value! Caution when comparing.

There are very different insulation values:

- Component tested U-value by independent institute, test certificate Entire component tested in heater box process, DIN EN ISO 12567
- Calculation by independent institute with documentation
- △ Internal calculation by manufacturer without documentation
- △ Pure assertion without any proof

Therefore: Demand a documentation for the U-value.

**Insist on the test certificate!**

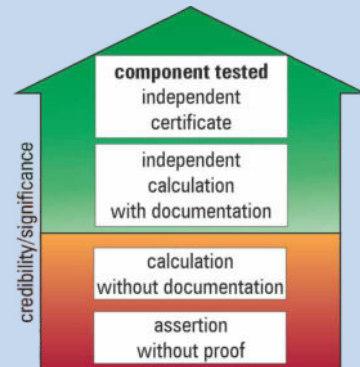

## Wellhöfer attic stairs with thermal protection WS: Much more than just an U-value.

### Tightness: Stop energy waste and mould formation!

Even the best insulation stays without effect, when air escapes through gaps.

**All Wellhöfer attic stairs with thermal protection WS always contain the tested ceiling connection system.**

- Specially developed **hoka twin-wall sealing** for tight closing **Class 4 component tested** (DIN EN 12207)
- **Ceiling connection system** for tight performance of the installation gap **a-value 0.01 component tested** (i. acc. DIN EN 1026)
- **Double sealing and PH-connection system** for significant reduction of thermal bridges, **Passive House certificate** (for thermal protection WSPH) Patent 10 2015 105 765



**Attic stairs:**  
Air-tight as windows



**Ceiling connection:**  
10x more air-tight than required for joints

### Climate tested: Stable and permanently tight.

Damp, warm air from the living space below, cold air in the attic above, strong variations in temperatures and humidity. Attic stairs must stay stable under these climate conditions. Wellhöfer attic stairs with thermal protection exceed the requirements for home entrance / basement entrance doors.

**Tested climate stability Class 3** (i. acc. DIN EN 12219)



**Climate stability:**  
Better than required for home entrance doors

# Fire protection attic stairs in fire resistant ceilings: Safety with tender, installation and in case of fire.

Always the matching attic stairs to every fire protection requirement:

		<b>Fire resistance</b> <b>30 minutes from below</b> DIN 4102-2, EI <sub>30</sub> (ÖNORM B 3860) In combination with thermal protection WSPH certified as Passive House Component.
		<b>Fire resistance</b> <b>30 minutes from top and bottom</b> DIN 4102-2
		<b>Fire resistance</b> <b>90 minutes from top and bottom</b> DIN 4102-2

Any attic stairs is available with any fire protection. All products are low-emission-tested and climate neutral. Currently unavoidable emissions compensated by climate protection certificates.

## Safe to install: Tested connection system instead of mortar or mineral wool

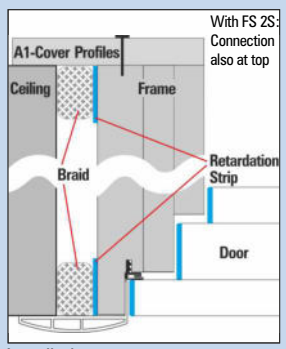

Installation

With Wellhöfer fire protection attic stairs, the certified connection system is always included and easy to install.

- Certified for 2 cm gap width for easy-installation
- Retardation strip already attached to the hatch
- **Push the braid circumferentially into the installation gap**
- Upper cover profiles (with FS90 2S)
- Sealing tape for airtight gap (with WS3D/WS4D)
- Connection for certified passive house gap (with WSPH)

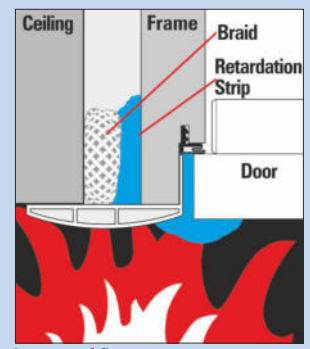

In case of fire

## Especially important for fire protection: Dimensions! Completed, fire resistance compliant ceiling opening!

Dimensions in centimetres	FS30	FS30 2S	FS90 2S
Ceiling opening dimensions (Length x Width)	min. 80* x 50 max. 160 x 80	min. 85* x 50 max. 140 x 80	min. 90 x 55 max. 140 x 70
Ceiling thickness = casing height	17 - 90	20 - 60	20 - 50
<b>Floor-to-ceiling heights</b> and type of stairs and add. features determine min. length of opening.			
Floor-to-ceiling height (min. - max.)	190 - 410**		

**Order with all 4 dimensions**

**Quick and error-free to the fitting attic stairs.**

**Use the configurator:**

[www.massbox.de](http://www.massbox.de)

Dimensions are construction site dimensions. Depending on the type of stairs and with further additional features divergent dimensions may apply. Ceiling opening dimensions = order dimensions. For installation space, factory-made casing dimensions are 1.5 cm (length/width) smaller.  
 \* We recommend a minimum length of at least 90 cm for the ceiling opening, otherwise the clearance will be very narrow!  
 \*\* For floor-to-ceiling heights 320 cm and higher the concertina stair type LiliPut always requires the comfort operation for the stair section.

## Important: Execution of the ceiling opening!

The ceiling opening on site must satisfy the fire resistance requirements:

- All-round and on the complete finished ceiling thickness
- If required, replacement with frame construction on the underside adapt to the thickness of the finished ceiling

The clear dimensions of the completed, fire resistance compliant ceiling opening, together with the floor-to-ceiling height, provide the 4 order dimensions for the attic stairs.

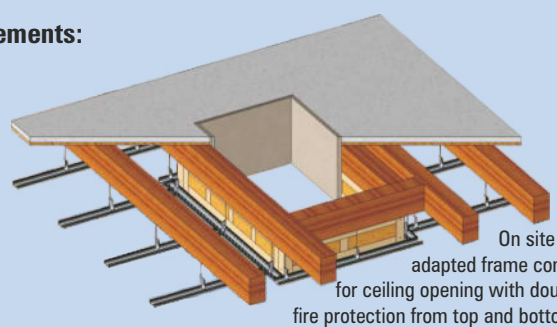

On site example:  
adapted frame construction for ceiling opening with double-sided fire protection from top and bottom FS 2S.

# Attic stairs - what is important?

- Does the **old loft ladder** in the existing building meet **today's requirements**?
- What should be considered when **choosing attic stairs** for a **new building**?



**Dangerous falling height!**

**Building regulations: Guardrail!**

**EN attic stairs regulations: Exit step at top end. Ceiling thickness!**

**EN attic stairs recommendation: Handrail!**

**EN attic stairs regulations: First step at base. Floor-to-ceiling height!**









## Install safely. And fast.

### Installation box: Small box - big advantages

Wellhöfer attic stairs with thermal protection WS or fire protection FS are always supplied with the complete installation material. The tested ceiling connection systems for airtight / fire resistant execution of the installation joint are also included in the installation box. The QR codes on the installation guides lead directly to short video clips demonstrating the particular installation step.



### Wellhöfer installation assistance:

#### This installation charger pays off.

The installation assistance **speeds up the installation of Wellhöfer attic stairs**. Makes exact alignment of the casing even faster and easier.

**Pays for itself from the 5th attic stairs onward.**



So far German only.  
Sorry for the inconvenience.

**Use configurator:**  
[www.massbox.de](http://www.massbox.de)

Please use internet browser for translation



# Safely ordering attic stairs: Always use all ④ dimensions!

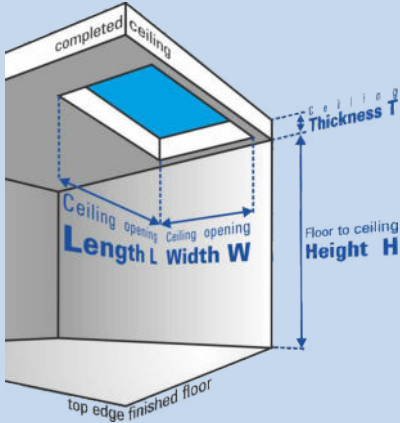

- **Ceiling opening Length L**
  - **Ceiling opening Width W**
  - **Ceiling Thickness (casing height) T**  
(provides EN compliant additional step if required due to high casing)
  - **Floor-to-ceiling Height H**  
(provides fitting stairs with EN compliant step distance)
- Do not forget:
- **Guardrail**
  - **Handrail**



Dimension check, price calculation, pdf/text-copy-function.

## Ceiling opening (length x width) and casing size

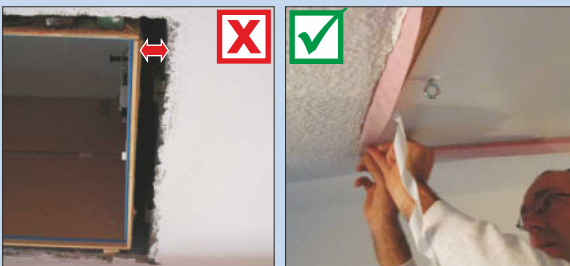

**Length and width of the ceiling opening** determine the order dimensions for the attic stairs. Then no adjustments need to be executed on site. **All fits:** Ceiling connection system, adjustment screws, cover profiles.

Ceiling opening dimensions = order dimensions. For installation space, factory-made casing dimensions are 1.5 cm (length/width) smaller.

**Wellhöfer attic stairs are available for ceiling openings with lengths 75 - 160 cm and widths 50 - 100 cm.**

## Completed ceiling thickness and casing height

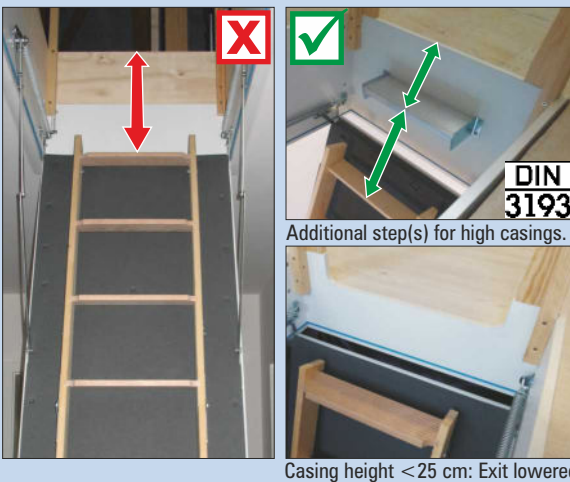

Casing height <25 cm: Exit lowered.

The ceiling thickness is another **important order specification!** Besides the visual aspect, it is mainly a matter of **user safety**. A too big distance between the top step and the loft floor is a **dangerous fall trap!** Depending on the ceiling thickness, if necessary, Wellhöfer installs EN compliant **additional step(s)** in high casings.

The correct height of the casing is also important for the prescribed **guardrail**. If the casing is lower than the ceiling thickness, the guardrail sits too low and does not reach the required 90 cm railing height!

Low casings therefore are only lowered at the exit to heights <25 cm.

**Wellhöfer attic stairs are available for ceiling thicknesses 17 - 90 cm.**

## Floor-to-ceiling height and stair part

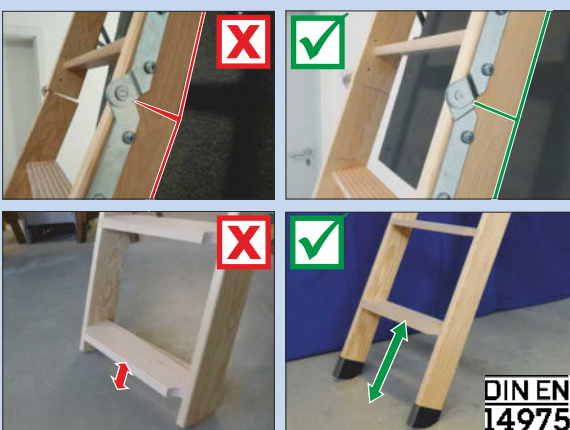

**This is where most mistakes are made!** Wooden stairs often have to be sawn down to match the existing floor-to-ceiling height. In addition, many stairs are adjusted incorrectly. Both aspects lead to **tripping hazards** and **endanger the long-term safety** of the stairs!

When ordered with the **actual existing floor-to-ceiling height**, Wellhöfer always provides the **fitting stairs with EN compliant step spacing**. No sawing needs to be done on site. **Floor-to-ceiling height, type of stairs and additional features determine the minimum length of the ceiling opening!**

**Wellhöfer attic stairs are available for floor-to-ceiling heights 190 - 410 cm.**

# Wellhöfer - We stand up to our responsibilities

Stairs from Würzburg for more than 70 years

## Health



Our products are often installed in residential buildings, attic stairs usually in the hallway between the bedroom and the children's room. Healthy living is a high priority for us. Our products are tested on low-emission and provide certified sustainability.

**LOW-EMISSION PRODUCTS**  
according to the criteria of



**SENTINEL HAUS  
INSTITUT**



## Environment



We have been self-sufficient in heating for decades and cover our energy needs with photovoltaics. We are permanently working on CO<sub>2</sub> reduction. Currently unavoidable emissions are compensated with climate protection certificates.



**CLIMATE NEUTRAL  
PRODUCTS**

certified by fokus-zukunft.com/10014  
Currently unavoidable emissions compensated  
by climate protection certificates

## Social



In 2011 we became part of the over 440 years old Juliusspital Foundation. Since we joined, we have continuously and reliably supported this renowned foundation in its many social tasks (retirement home, hospice, clinic).

# Gutfühlen mit Wellhöfer



**wellhöfer**  
**TREPPEN AUS WÜRZBURG**  
**www.wellhoefer.de**



Wellhöfer Treppen GmbH & Co.KG  
Max-Mengeringhausen-Straße 1  
97084 Würzburg, Germany

info@wellhoefer.de  
Tel. +49 (0)9 31 / 6 14 05-0  
Fax +49 (0)9 31 / 6 14 05 71