

Installation Guide Attic Hatch ceiling-flush version with easy-installation system

⚠ Time of installation: Watch humidity at construction site!
 Only install attic stairs when standard climate has been established.
 Always install attic hatch without stairs.

Annually inspect in order to ensure that all screws and nuts, except for those at the rotation points of the levers, are tightened securely. Make sure to lubricate all joints / rotation points with oil once a year.

1 Set up frame vertically.

Screw ring eye by hand flush into catch. Do not overtighten! Do not scratch!

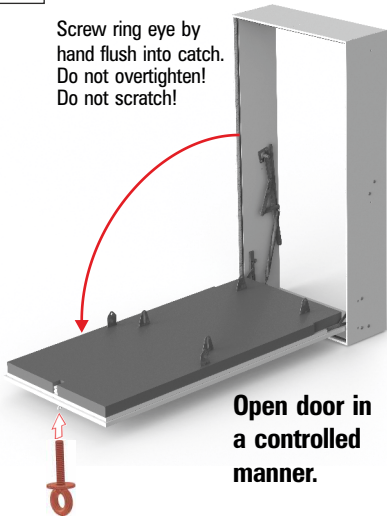

Open door in a controlled manner.

2 Detach door:

Loosen 2 screws on each side from the easy-installation system. Slide door with mounting plates upwards out of the guide rails towards the opening side.

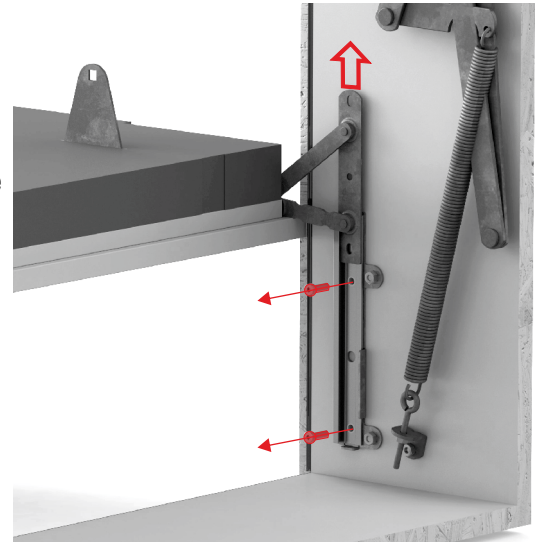

⚠ Before hanging the attic hatch: Glue sealing tape into the ceiling opening!
 (Installation Guide Connection System)

3 Strap two roof battens, hinge-in casing frame and align it horizontally with wooden wedges (spirit level)

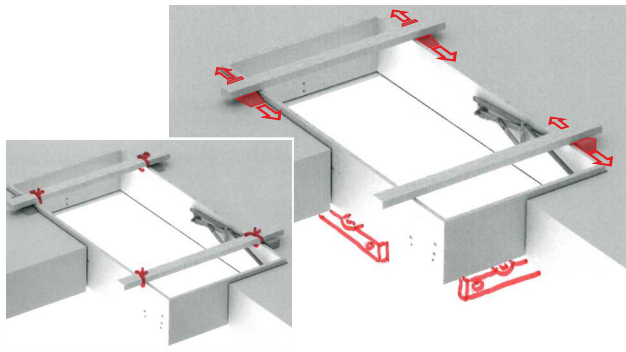

Align casing frame flush with ceiling:

A) Ceiling already finished

B) Plasterboard not yet installed:

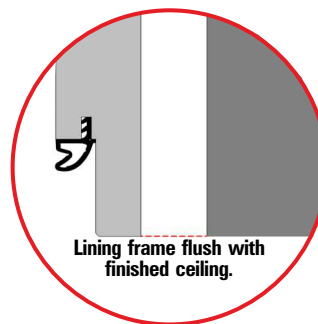

Lining frame flush with finished ceiling.

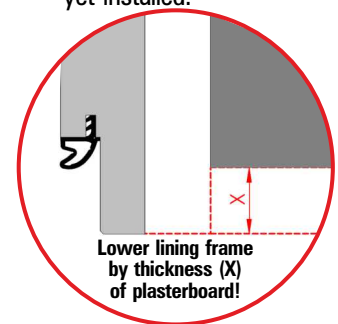

Lower lining frame by thickness (X) of plasterboard!

4 Underlay at pre-drilled holes. For concrete ceiling, use 8-mm dowels.

Screw in adjusting screws (6x).

Align casing frame to right angle!
Center in the middle of the ceiling opening.

Important:

Remeasure diagonals. Insert door for testing and balance distance between casing frame and door along the longitudinal sides.

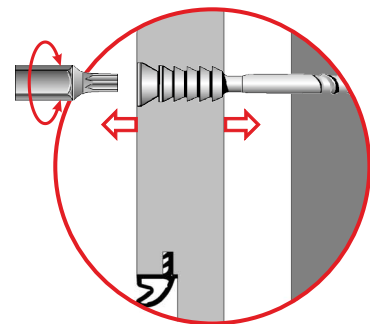
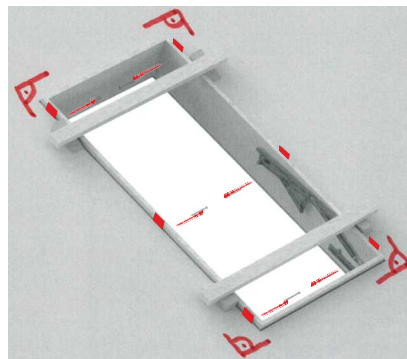

At end of installation:
 Close mounting holes with cover caps.

⚠ Fix casing frame vibration-free!
 e.g. with installation foam

Installation Guide Attic Hatch ceiling-flush version with easy-installation system

! Before mounting the plastering profiles:
 - Push insulation braid into the gap!
 - Glue sealing tape on frame bar!
 (Installation Guide Connection System)

5 When the ceiling (incl. plasterboard) is fully installed:
Install plastering profiles (Installation Guide Plastering Profiles)
 Plastering

6 **Attach door**
 Place mounting plates on guide rails and slide door backwards. Tighten the 2 screws on each side.

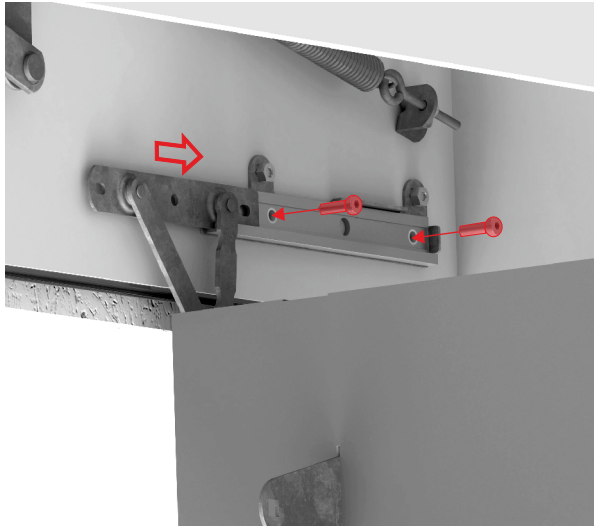

Fine adjustment
 The door position (front/rear, top/bottom) can be finely adjusted using the slotted holes in the plates and rails.



It is NOT possible to compensate for a distorted lining frame!

! As long as levers are not yet attached, door swings open uncontrollably!

7 **Attach levers one after the other(!):**

- Set up first lever by hand

- Pull first lever downwards

! Do not let go!
Spring tension!

- Fasten first lever inside the support

After tightening, loosen by 1/2 turn
 (rotation point).

Then attach second lever identically.

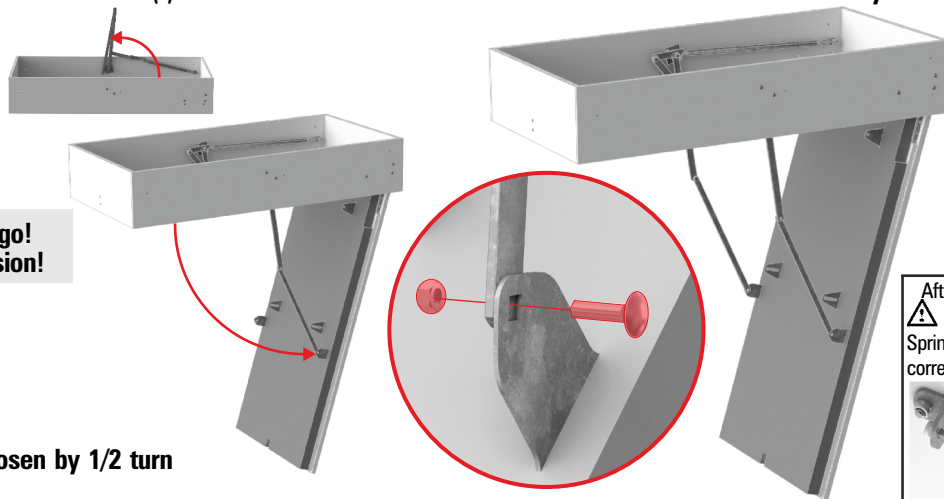

After lever assembly:
! Spring check!
 Spring hook must hang correctly in the eyelet:



Installation of stairs (Installation Guide Stairs)

! **User safety: Guardrail!**
 Installation possible at any later point.

weilhöfer
TREPPEN AUS WÜRZBURG
www.weilhoefer.de

Installation Guide Connection System

! Always apply sealing tape to ceiling opening prior to installation of attic hatch!
Watch ceiling construction! (see below)



1 Glue sealing tape in place:

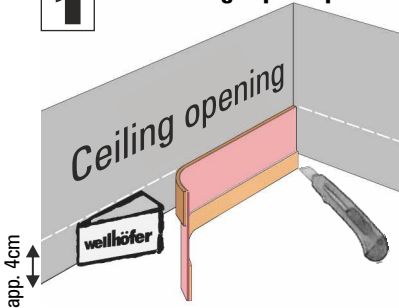

Cut off in corners and re-apply.

3 Push in insulation braid:

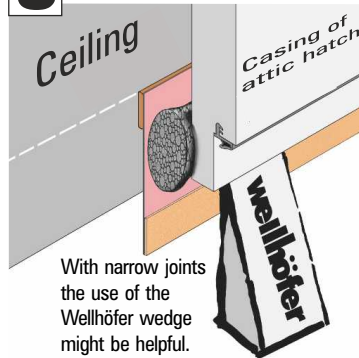

With narrow joints the use of the Wellhöfer wedge might be helpful.

Cut off in corners and re-apply. For close connection upset joints in the corners.



For attic stairs with fire protection FS:
 Push in hardly flammable fire protection braid instead of insulating braid!
 (Installation Guide Attic Stairs FS)

4 Close the gap:

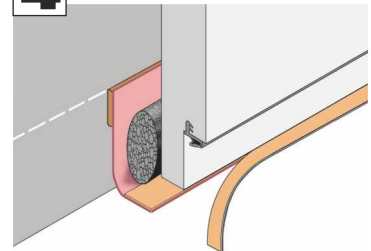

If required, cut projecting tape flush with joint angles.

Glue sealing tape to lining bar all over.

2 Install attic hatch (Installation Guide Attic Stairs / Access Hatch)

5 Install cover profiles (Installation Guide Cover Profiles)

Full effect is gained only if the ceiling connection system has been implemented as described above.



Correct air-tight connection:

! Glue **Wellhöfer sealing tape** tightly and securely onto the **on-site air-tight barrier!**
Watch ceiling construction / thermal bridges / fire protection regulations and where necessary fill additional insulation into gap on-site.



Concrete ceiling

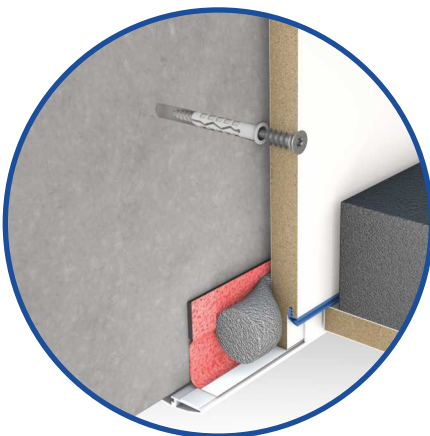

Suspended ceiling

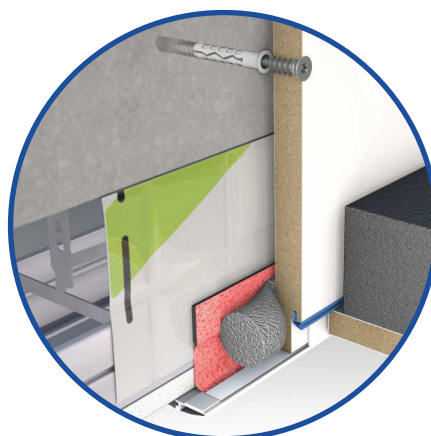

Wodden beam ceiling with counter battens



Installation Guide plastering profiles for ceiling-flush version

 **The hatch must be installed vibration-free!**

Tip for precise and clean installation: Detach the hatch door

- 1** **Setting and fixing plastering strips:**
Put the plastering stripes (on mitre) into the fold of the hatch frame. Fix them in place (use clips/tacker).



-  **Tip for professional execution:**
Attach fabric tape on site

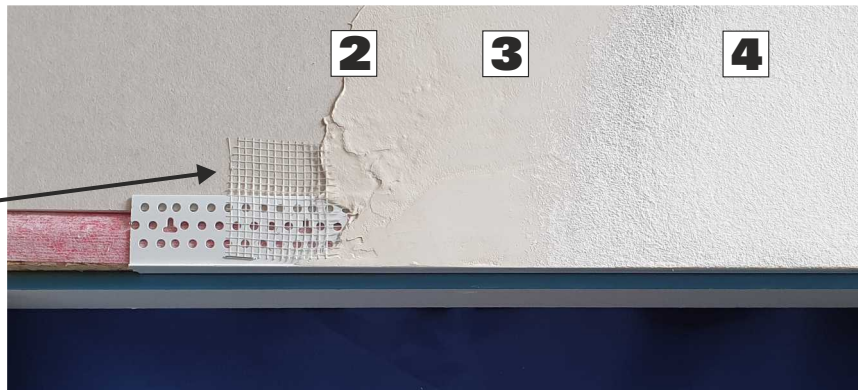
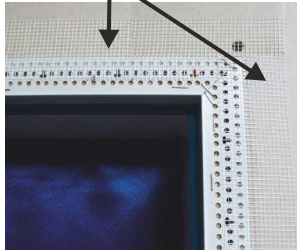

2 Apply plaster

3 Grind

4 Paint

weilhöfer
TREPPEN AUS WÜRZBURG

Installation Guide Stairs

DIN EN 14975 **DIN 3193**

All attic stairs are manufactured in accordance with DIN-EN and are overload method tested for a load of 150 kg (AluDrei for 200 kg).

! Correct height adjustment: The installation of the floor must be completed entirely.

3-section: GutHolz / AluDrei / StahlBlau

1 Fasten stairs with screws **within supports**. Install handrail (Installation Guide Handrail).

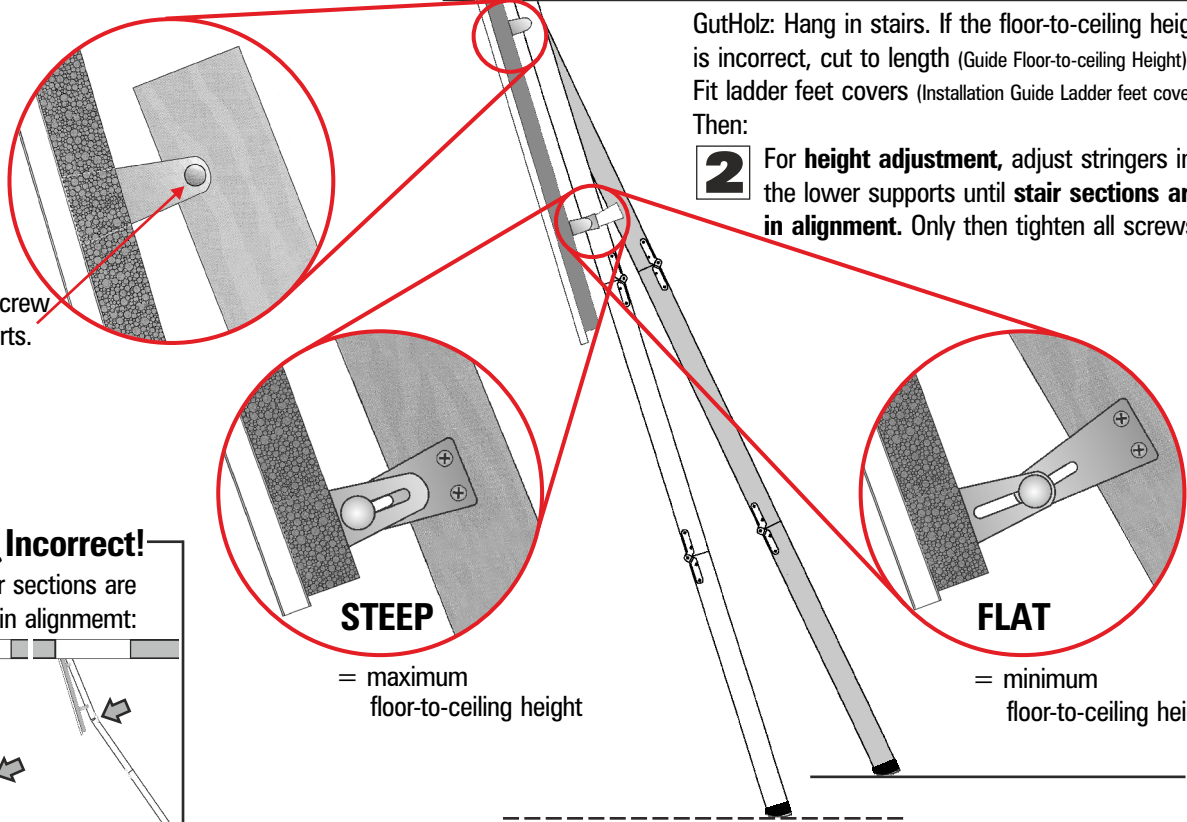

GutHolz: Hang in stairs. If the floor-to-ceiling height is incorrect, cut to length (Guide Floor-to-ceiling Height)
Fit ladder feet covers (Installation Guide Ladder feet covers)
Then:

2 For **height adjustment**, adjust stringers in the lower supports until **stair sections are in alignment**. Only then tighten all screws.

Fasten screw in supports.

! **Incorrect!**

Stair sections are not in alignment:

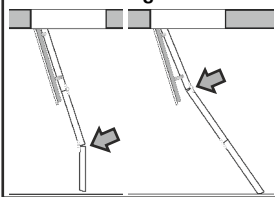

STEEP

= maximum floor-to-ceiling height

FLAT

= minimum floor-to-ceiling height

Concertina: LiliPut In case of LiliPut with comfort operation pay attention: Installation guide LiliPut comfort operation

1 Loosen the two upper screw nuts of the stair.

2 Fasten stair with screws **within supports**.

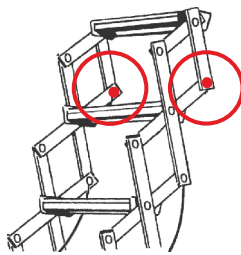

Install handrail telescope
(Installation Guide LiliPut Handrail Telescope)

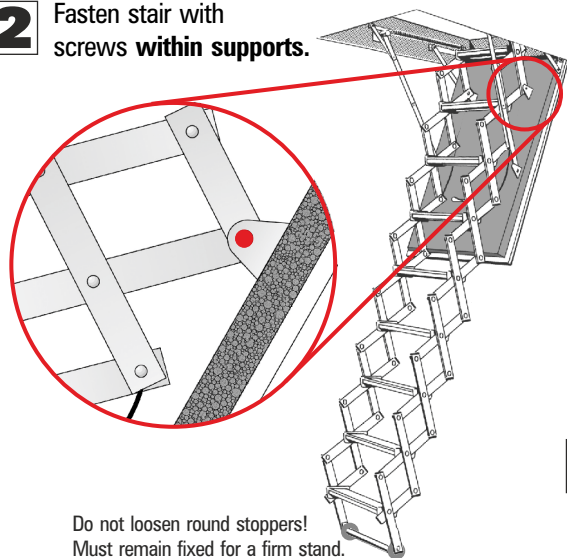

Do not loosen round stoppers!
Must remain fixed for a firm stand.

3 Align stairs parallel to the fully opened door. Check secure stand.

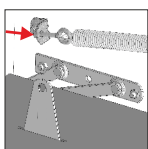

When installation is completed, **check tight closing of the hatch door** and fine tune the factory setted spring tension if necessary (nut at ringscrew).
Springs are under tension!
Therefore only adjust from above with hatch door closed.

Note cladding: thickness maximum 20 mm, use longer ring eye screw; distributed load maximum 10 kg/m²; gap width between hatch door and frame minimum 3.5 mm. Hatch door > 1 m² use stronger springs.

weilhöfer
TREPPEN AUS WÜRZBURG