

Wellhöfer range

- Attic stairs
- Flat roof exits
- Wall hatches
- Access hatches
- Space-saving stairs



**CLIMATE NEUTRAL
PRODUCTS**

certified by fokus-zukunft.com/10014
Currently unavoidable emissions compensated
by climate protection certificates

LOW-EMISSION PRODUCTS
according to the criteria of



**SENTINEL HAUS
INSTITUT**

Wellhöfer product range

Contents

■ Attic stairs

■ Attic stairs overview	3
■ Attic stairs GutHolz	4/5
■ Attic stairs AluDrei	6/7
■ Attic stairs StahlBlau	8/9
■ Concertina Liliput	10/11
■ Concertina loft ladder with backboard	12
■ Attic stairs additional features	13
■ Thermal protection WS for attic stairs	14
■ Fire protection FS for attic stairs	15
■ Attic stairs safety	16
■ How to order attic stairs	17

■ Flat roof exits	18/19
--------------------------	--------------

■ Wall hatches	20-23
-----------------------	--------------

■ Access hatches	24/25
-------------------------	--------------

■ Space-saving stairs	26/27
------------------------------	--------------

■ Wellhöfer responsibility	28
-----------------------------------	-----------

Always the fitting attic stairs



Flat roof exits

18/19



Access hatches

24/25



Concertina loft ladder with backboard

12



Beautiful space-saving stairs

26/27



A wide variety of wall hatches

20-23



Wellhöfer attic stairs range

GutHolz, AluDrei, StahlBlau and Liliput as standard with **thermal protection WS3D** (U-value 0.80, air-tightness Class 4, connection system)

				
StirnBrett	GutHolz	AluDrei	StahlBlau	LiliPut
Concertina loft ladder with backboard <i>Details page 12</i>	Always the right choice 3-section, wood, step depth 9 cm	For highest resilience 3-section, alu, step depth 11 cm	For special requirements 3-section, steel, step depth 11 cm	Comfort within little space Concertina, alu, step depth 11 cm

Standard sizes						
Ceiling opening dimensions (Length x Width)	110 x 60	120 x 60	130 x 60	140 x 60	90 x 60	100 x 60
	110 x 70	120 x 70	130 x 70	140 x 70	90 x 70	100 x 70
Casing height (ceiling thickness)	25					
Custom-made Divergent dimensions with thermal protection WS4D/WSPH, fire protection and flat roof exit.						
Ceiling opening dimensions (Length x Width)	min. 100 x 50			min. 105 x 60		min. 75* x 50
	max. 160 x 100			max. 160 x 100		max. 160 x 100
Casing height (ceiling thickness)	17 - 90					
Floor to ceiling heights Floor to ceiling height, type of stairs and additional features determine the minimum length of the ceiling opening!						
Floor to ceiling height (min. - max.)	197 - 360			237 - 314		190 - 410**

Dimensions are construction side dimensions in centimetres. Divergent dimensions may apply in combination with additional features. Ceiling opening dimensions = order dimensions. For installation space, factory-made casing dimensions are 1.5 cm (length/width) smaller.

* We recommend a minimum length of at least 90 cm for the ceiling opening, otherwise the clearance will be very narrow!

** Floor to ceiling heights 320 cm and higher always require the comfort operation for the concertina attic stairs Liliput.

Additional features Always order together with the attic stairs. Guardrail and handrail retrofittable.

Safety and comfort Features for all requirements and demands.				
Guardrail	Tested stability, required by building regulations			
Handrail	Handrail wood GH/SB	AluDrei-Handrail wood	Handrail wood GH/SB	Handrail telescope
Operation stairs				Comfort operation
Lock	with round cylinder / with profile cylinder / prepared for profile cylinder			
Wide cover profiles	55 mm wide, in combination with custom-made attic stairs, as standard with WSPH			
Energy conservation Save more energy with better thermal protection				
Thermal protection WS4D	Double insulation + sealing + connection system. Component tested U-value 0.58			
Thermal protection WSPH	Certified Passive House component for cold climate. Minimized thermal bridges. U ₀ 0.48			
Fire protection Incl. certified ceiling connection system for safe installation				
Fire protection FS30	Fire resistance 30 minutes from below			
Fire protection FS30 2S	Fire resistance 30 minutes from top and bottom			
Fire protection FS90 2S	Fire resistance 90 minutes from top and bottom			
Flat roof Safe access to the flat roof				
Flat roof exit	Rear ventilation. One-hand operation. Available for all types of attic stairs and additional features.			

Use configurator:
www.massbox.de



GutHolz



Photo shows attic stairs GutHolz with thermal protection WS4D and handrail



**CLIMATE NEUTRAL
PRODUCT**

certified by fokus-zukunft.com/10014
Currently unavoidable emissions compensated
by climate protection certificates

LOW-EMISSION PRODUCT
according to the criteria of



**SENTINEL HAUS
INSTITUT**

Always the right choice

Reliable 3-section wooden attic stairs

GutHolz

Attic stairs GutHolz

- 9 cm deep, corrugated hardwood steps
- Stair width up to 40 cm
- Solid wood stringers and hardwood treads in stable dovetail joint
- EN-compliant step distance without sawing off

When ordered with the actual floor to ceiling height, the fitting stairs is supplied

Standard advantages

- **Tested low-emission product**
Significantly below the limit values of the Sentinel Haus Institute
- **Certified climate neutral product**
Currently unavoidable emissions compensated by climate protection certificates
- **Suitable for all roof constructions**
From ventilated to cold roof
- **With thermal protection WS3D**
Tested insulation U-value 0.80, air-tightness Class 4, climate stability Class 3
- **15 years manufacturer's guarantee on function**



Dimensions in centimetres

Standard sizes				
Ceiling opening dimensions (Length x Width)	110 x 60	120 x 60	130 x 60	140 x 60
	110 x 70	120 x 70	130 x 70	140 x 70
Ceiling thickness = casing height	25			
Custom-made				
Ceiling opening dimensions (Length x Width)	min. 100 x 50 max. 160 x 100			
Ceiling thickness = casing height	17 - 90			
Floor to ceiling heights and additional features determine minimum length of the ceiling opening				
Floor to ceiling height (min. - max.)	197 - 360			

Order with all 4 dimensions

MassBox Quick and error-free to the fitting attic stairs. Use the configurator: www.massbox.de

Dimensions are construction side dimensions for attic stairs GutHolz with thermal protection WS3D. Divergent dimensions may apply in combination with additional features. Ceiling opening dimensions = order dimensions. For installation space, factory-made casing dimensions are 1.5 cm (length/width) smaller.

Additional features

Energy conservation	Safety and comfort	Fire protection	Flat roof
Air-tightness Class 4, a-value 0.01, climate-stability Class 3. <ul style="list-style-type: none"> ■ Thermal protection WS4D U-value 0.58 Double insulation+sealing+connection system ■ Thermal protection WSPH Certified Passive House component for cold climate incl. PH-connection system 	<ul style="list-style-type: none"> ■ Guardrail Required by building regulations ■ Handrail Providing hold and safe grip ■ Lock 	Always with connection system. <ul style="list-style-type: none"> ■ Fire protection FS30 30 min. from below ■ Fire protection FS30 2S 30 min. from top and bottom ■ Fire protection FS90 2S 90 min. from top and bottom 	<ul style="list-style-type: none"> ■ Flat roof exit Available for all types of stairs and all variants of thermal and fire protection
Page 14	Page 13	Page 15	Page 18/19

Attic stairs AluDrei

AluDrei



Photo shows attic stairs AluDrei with thermal protection WS4D and handrail



**CLIMATE NEUTRAL
PRODUCT**

certified by fokus-zukunft.com/10014
Currently unavoidable emissions compensated
by climate protection certificates

LOW-EMISSION PRODUCT
according to the criteria of



**SENTINEL HAUS
INSTITUT**

For highest resilience

Stable and lightweight 3-section aluminium attic stairs

AluDrei

Attic stairs AluDrei

- **Overload method tested for 200 kg loading**
- **11 cm deep, corrugated steps**
- **Stair width up to 40 cm**
- **Stringers made of aluminium profile with rounded edges**

Standard advantages

- **Tested low-emission product**
Significantly below the limit values of the Sentinel Haus Institute
- **Certified climate neutral product**
Currently unavoidable emissions compensated by climate protection certificates
- **Suitable for all roof constructions**
From ventilated to cold roof
- **With thermal protection WS3D**
Tested insulation U-value 0.80, air-tightness Class 4, climate stability Class 3
- **15 years manufacturer's guarantee on function**



Dimensions in centimetres

Standard sizes				
Ceiling opening dimensions (Length x Width)	110 x 60	120 x 60	130 x 60	140 x 60
	110 x 70	120 x 70	130 x 70	140 x 70
Ceiling thickness = casing height	25			
Custom-made				
Ceiling opening dimensions (Length x Width)	min. 100 x 50 max. 160 x 100			
Ceiling thickness = casing height	17 - 90			
Floor to ceiling heights and additional features determine minimum length of the ceiling opening				
Floor to ceiling height (min. - max.)	197 - 360			

Order with all 4 dimensions



Quick and error-free to the fitting attic stairs.
Use the configurator:
www.massbox.de

Dimensions are construction side dimensions for attic stairs AluDrei with thermal protection WS3D. Divergent dimensions may apply in combination with additional features. Ceiling opening dimensions = order dimensions. For installation space, factory-made casing dimensions are 1.5 cm (length/width) smaller.

Additional features

Energy conservation	Safety and comfort	Fire protection	Flat roof
Air-tightness Class 4, a-value 0.01, climate-stability Class 3. <ul style="list-style-type: none"> ■ Thermal protection WS4D U-value 0.58 Double insulation+sealing+connection system ■ Thermal protection WSPH Certified Passive House component for cold climate incl. PH-connection system 	<ul style="list-style-type: none"> ■ Guardrail Required by building regulations ■ AluDrei-handrail wood Providing hold and safe grip ■ Lock 	Always with connection system. <ul style="list-style-type: none"> ■ Fire protection FS30 30 min. from below ■ Fire protection FS30 2S 30 min. from top and bottom ■ Fire protection FS90 2S 90 min. from top and bottom 	<ul style="list-style-type: none"> ■ Flat roof exit Available for all types of stairs and all variants of thermal and fire protection
Page 14	Page 13	Page 15	Page 18/19

StahlBlau



**CLIMATE NEUTRAL
PRODUCT**

certified by fokus-zukunft.com/10014
Currently unavoidable emissions compensated
by climate protection certificates

LOW-EMISSION PRODUCT
according to the criteria of



**SENTINEL HAUS
INSTITUT**

For special requirements

Robust 3-section steel attic stairs

StahlBlau

- 11 cm deep steps with non-slip mats
- Stair width 40 cm
- Wear- and corrosion-resistant surface
Double lacquered
- Very stable design

Standard advantages

- **Tested low-emission product**
Significantly below the limit values of the Sentinel Haus Institute
- **Certified climate neutral product**
Currently unavoidable emissions compensated by climate protection certificates
- **Suitable for all roof constructions**
From ventilated to cold roof
- **With thermal protection WS3D**
Tested insulation U-value 0.80, air-tightness Class 4, climate stability Class 3
- **15 years manufacturer's guarantee on function**



Dimensions in centimetres

Standard sizes				
Ceiling opening dimensions (Length x Width)	110 x 60	120 x 60	130 x 60	140 x 60
	110 x 70	120 x 70	130 x 70	140 x 70
Ceiling thickness = casing height	25			
Custom-made				
Ceiling opening dimensions (Length x Width)	min. 105 x 60 max. 160 x 100			
Ceiling thickness = casing height	17 - 90			
Floor to ceiling heights and additional features determine minimum length of the ceiling opening				
Floor to ceiling height (min. - max.)	237 - 314			

Order with all 4 dimensions

MassBox Quick and error-free to the fitting attic stairs. Use the configurator: www.massbox.de



Dimensions are construction side dimensions for attic stairs StahlBlau with thermal protection WS3D. Divergent dimensions may apply in combination with additional features. Ceiling opening dimensions = order dimensions. For installation space, factory-made casing dimensions are 1.5 cm (length/width) smaller.

Additional features

Energy conservation	Safety and comfort	Fire protection	Flat roof
Air-tightness Class 4, a-value 0.01, climate-stability Class 3. <ul style="list-style-type: none"> ■ Thermal protection WS4D U-value 0.58 Double insulation+sealing+connection system ■ Thermal protection WSPH Certified Passive House component for cold climate incl. PH-connection system 	<ul style="list-style-type: none"> ■ Guardrail Required by building regulations ■ Handrail Providing hold and safe grip ■ Lock 	Always with connection system. <ul style="list-style-type: none"> ■ Fire protection FS30 30 min. from below ■ Fire protection FS30 2S 30 min. from top and bottom ■ Fire protection FS90 2S 90 min. from top and bottom 	<ul style="list-style-type: none"> ■ Flat roof exit Available for all types of stairs and all variants of thermal and fire protection
Page 14	Page 13	Page 15	Page 18/19

LiliPut



**CLIMATE NEUTRAL
PRODUCT**

certified by fokus-zukunft.com/10014
Currently unavoidable emissions compensated
by climate protection certificates

LOW-EMISSION PRODUCT
according to the criteria of



**SENTINEL HAUS
INSTITUT**

Comfort within little space

High-quality aluminium concertina attic stairs

LiliPut

Concertina attic stairs LiliPut

- 11 cm deep, corrugated steps
- Stair width up to 40 cm
- Elegant design with aluminium profiles
- **Comfort operation stair section**
For floor to ceiling heights 320 - 410 cm always included, up to 319 cm optional



Comfort operation stair section

Standard advantages

- **Tested low-emission product**
Significantly below the limit values of the Sentinel Haus Institute
- **Certified climate neutral product**
Currently unavoidable emissions compensated by climate protection certificates
- **Suitable for all roof constructions**
From ventilated to cold roof
- **With thermal protection WS3D**
Tested insulation U-value 0.80, air-tightness Class 4, climate stability Class 3
- **15 years manufacturer's guarantee on function**



Dimensions in centimetres

Standard sizes	
Ceiling opening dimensions (Length x Width)	90 x 60 100 x 60 90 x 70 100 x 70
Ceiling thickness = casing height	25
Custom-made	
Ceiling opening dimensions (Length x Width)	min. 75* x 50 max. 160 x 100
Ceiling thickness = casing height	17 - 90
Floor to ceiling heights and additional features determine minimum length of the ceiling opening	
Floor to ceiling height (min. - max.)	190 - 410**

Order with all 4 dimensions

MassBox Quick and error-free to the fitting attic stairs.

Use the configurator: www.massbox.de

Dimensions are construction side dimensions for attic stairs LiliPut with thermal protection WS3D. Divergent dimensions may apply in combination with additional features. Ceiling opening dimensions = order dimensions. For installation space, factory-made casing dimensions are 1.5 cm (length/width) smaller.

* We recommend a minimum length of at least 90 cm for the ceiling opening, otherwise the clearance will be very narrow!

** Floor to ceiling heights 320 cm and higher always require the comfort operation for the stair section.

Additional features

Energy conservation	Safety and comfort	Fire protection	Flat roof
Air-tightness Class 4, a-value 0.01, climate-stability Class 3. <ul style="list-style-type: none"> ■ Thermal protection WS4D U-value 0.58 Double insulation+sealing+connection system ■ Thermal protection WSPH Certified Passive House component for cold climate incl. PH-connection system 	<ul style="list-style-type: none"> ■ Guardrail Required by building regulations ■ Handrail telescope Providing hold and safe grip ■ Lock 	Always with connection system. <ul style="list-style-type: none"> ■ Fire protection FS30 30 min. from below ■ Fire protection FS30 2S 30 min. from top and bottom ■ Fire protection FS90 2S 90 min. from top and bottom 	<ul style="list-style-type: none"> ■ Flat roof exit Available for all types of stairs and all variants of thermal and fire protection
Page 14	Page 13	Page 15	Page 18/19

StirnBrett

- 11 cm deep, corrugated steps
- Stair width 40 cm
- For ceiling openings from 80 x 60 cm

Suitable for replacing an old loft ladder, refitting an existing attic hatch or under skylight windows.

The concertina loft ladder can be fixed into openings as small as 80 x 60 cm (L x W). The 11 cm deep, corrugated aluminium steps provide safety and comfort. The loft ladder is easy to operate due to its light weight (extruded aluminium).

Backboard (plywood, thickness 18 mm, 41.2 x 17.6 cm), fixing screws, holding brackets for ladder, hook for tension rod are included in the scope of delivery.

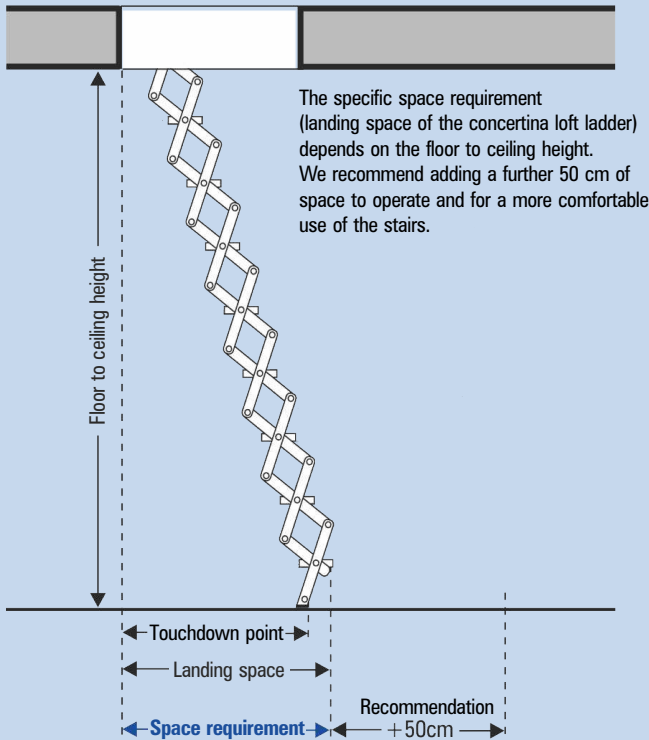

Measurements:

Steps	Floor to ceiling height	Space requirement
9	214 - 242	91
10	243 - 269	100
11	270 - 296	108
12	297 - 320	117

Measurements in centimetres. We recommend adding a further 50 cm of space to operate and for a more comfortable use of the stairs.

Aluminium concertina loft ladder with backboard

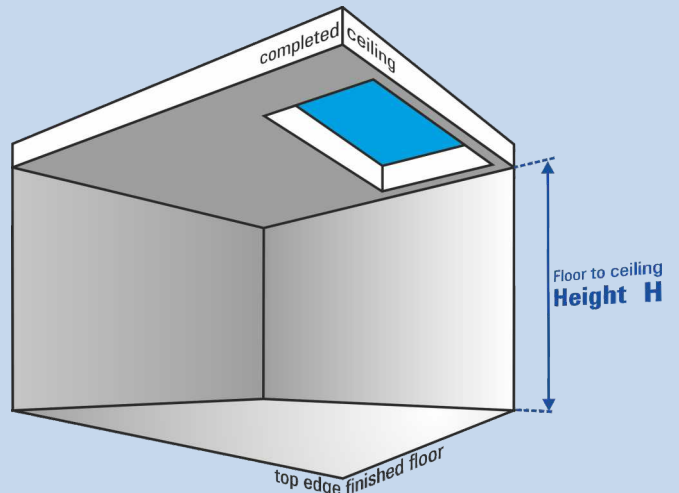

Order dimensions = floor to ceiling height:
Height between finished floor and completed ceiling.



LOW-EMISSION PRODUCT according to the criteria of



Additional features for Wellhöfer attic stairs

Safety, comfort, optics



Guardrail

The guardrail is required by the building regulations - even in owner-occupied homes. The Wellhöfer guardrail is **stability-tested**, is supplied with the complete fastening material and can be retrofittable.

Note: The casing height of the attic stairs must at least correspond to the ceiling thickness so that the railing height reaches the required 90 cm.



Handrail

The EN regulations for attic stairs recommend a handrail. Handrails are optionally available for the right, left and for both sides.

A **wooden handrail** provides grip when using the 3-section attic stairs GutHolz/AluDrei/StahlBlau.

For the concertina attic stairs Liliput, an aluminium **telescopic handrail** provides safety.

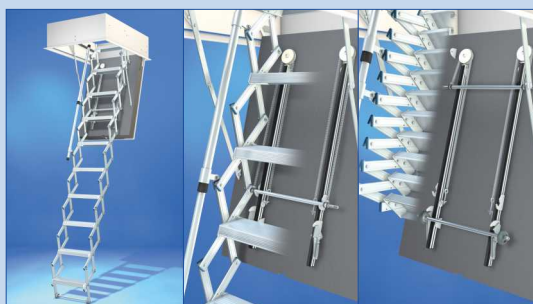

Comfort operation for Liliput stair section

The comfort operation **makes it easy to push in and pull out the concertina stair section** and **increases the stability** of the stairs.

For floor to ceiling heights of 320 cm and higher, every Liliput is therefore always equipped with the comfort operation. For lower floor to ceiling heights the comfort operation is optional.



Lock

Lock prepared for profile cylinder:

Available for all attic stairs types and features.

Lock with round cylinder:

Not available for attic stairs with double-sided fire protection (FS30 2S, FS90 2S).

Lock with profile cylinder:

Only available for attic stairs with double-sided fire protection (FS30 2S, FS90 2S).

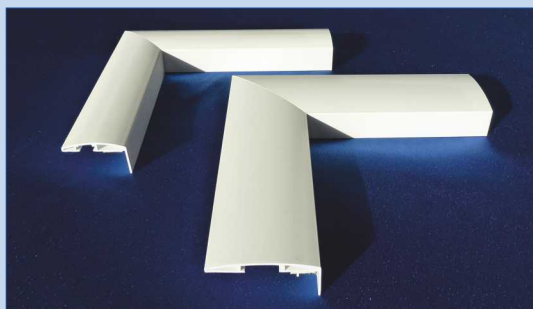

Wide cover profiles

As an option for custom-made attic stairs 55 mm wide cover profiles are available instead of the standard 40 mm wide profiles.

The wide cover profiles also have a **rounded profile** and are **always mitred to fit**. The **plugin-system** makes installation quick and easy.

Overlap (projection on the ceiling) in relation to the order dimension of the ceiling opening:

- Standard cover profiles: 2 cm
- Wide cover profiles for custom-made attic stairs: 3.5 cm
- Wide cover profiles as standard with thermal protection WSPH: 2.5 cm

4-way tested thermal protection WS for attic stairs: Insulation + sealing + ceiling connection + climate class

Very good as standard:

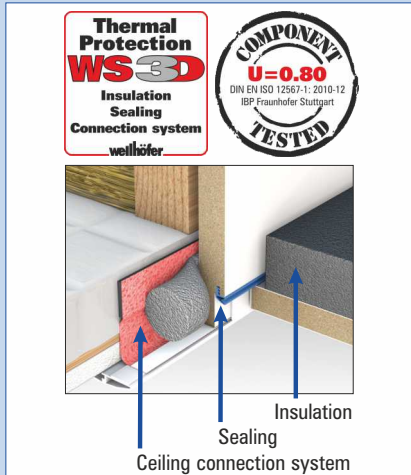

Better:



Best:



Even with standard thermal protection WS3D, Wellhöfer attic stairs are suitable for any roof construction.

Insulation: Honest U-value! Caution when comparing.

There are very different insulation values:

- Component tested U-value by independent institute, test certificate Entire component tested in heater box process, DIN EN ISO 12567
- Calculation by independent institute with documentation
- △ Internal calculation by manufacturer without documentation
- △ Pure assertion without any proof

Therefore: Demand a documentation for the U-value.

Insist on the test certificate!

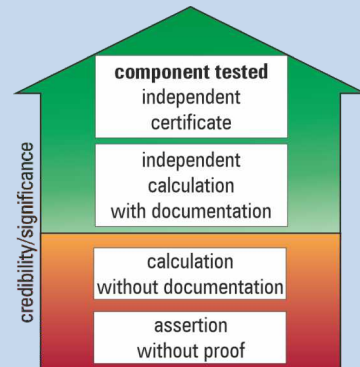

Wellhöfer attic stairs with thermal protection WS: Much more than just an U-value.

Tightness: Stop energy waste and mould formation!

Even the best insulation stays without effect, when air escapes through gaps.

All Wellhöfer attic stairs with thermal protection WS always contain the tested ceiling connection system.

- Specially developed **hoka twin-wall sealing** for tight closing
Class 4 component tested (DIN EN 12207)
- **Ceiling connection system** for tight performance of the installation gap
a-value 0.01 component tested (i. acc. DIN EN 1026)
- **Double sealing and PH-connection system** for significant reduction of thermal bridges, **Passive House certificate** (for thermal protection WSPH)
Patent 10 2015 105 765



Attic stairs:
Air-tight as windows



Ceiling connection:
10x more air-tight than required for joints

Climate tested: Stable and permanently tight.

Damp, warm air from the living space below, cold air in the attic above, strong variations in temperatures and humidity. Attic stairs must stay stable under these climate conditions. Wellhöfer attic stairs with thermal protection exceed the requirements for home entrance / basement entrance doors.

Tested climate stability Class 3 (i. acc. DIN EN 12219)



Climate stability:
Better than required for home entrance doors

Fire protection attic stairs in fire resistant ceilings: Safety with tender, installation and in case of fire.

Always the matching attic stairs to every fire protection requirement:

		Fire resistance 30 minutes from below DIN 4102-2, EI ₃₀ (ÖNORM B 3860) In combination with thermal protection WSPH certified as Passiv House Component.
		Fire resistance 30 minutes from top and bottom DIN 4102-2
		Fire resistance 90 minutes from top and bottom DIN 4102-2

Any attic stairs is available with any fire protection. All products are low-emission-tested and climate neutral. Currently unavoidable emissions compensated by climate protection certificates.

Safe to install: Tested connection system instead of mortar or mineral wool

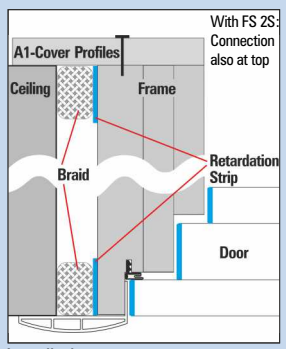

Installation

With Wellhöfer fire protection attic stairs, the certified connection system is always included and easy to install.

- Certified for 2 cm gap width for easy-installation
- Retardation strip already attached to the hatch
- **Push the braid circumferentially into the installation gap**
- Upper cover profiles (with FS90 2S)
- Sealing tape for airtight gap (with WS3D/WS4D)
- Connection for certified passive house gap (with WSPH)

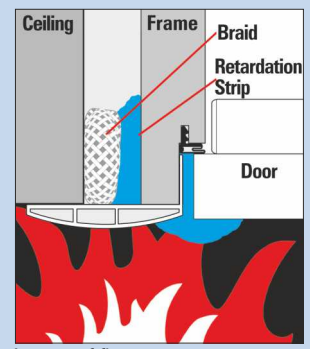

In case of fire

Especially important for fire protection: Dimensions! Completed, fire resistance compliant ceiling opening!

Dimensions in centimetres	FS30	FS30 2S	FS90 2S
Ceiling opening dimensions (Length x Width)	min. 80* x 50 max. 160 x 80	min. 85* x 50 max. 140 x 80	min. 90 x 55 max. 140 x 70
Ceiling thickness = casing height	17 - 90	20 - 60	20 - 50
Floor to ceiling heights and type of stairs and add. features determine min. length of opening.			
Floor to ceiling height (min. - max.)	190 - 410**		

Order with all 4 dimensions

Quick and error-free to the fitting attic stairs.

Use the configurator: www.massbox.de

Dimensions are construction side dimensions. Depending on the type of stairs and with further additional features divergent dimensions may apply. Ceiling opening dimensions = order dimensions. For installation space, factory-made casing dimensions are 1.5 cm (length/width) smaller.
 * We recommend a minimum length of at least 90 cm for the ceiling opening, otherwise the clearance will be very narrow!
 ** For floor to ceiling heights 320 cm and higher the concertina stair type LilliPut always require the comfort operation for the stair section.

Important: Execution of the ceiling opening!

The ceiling opening on site must satisfy the fire resistance requirements:

- All-round and on the complete finished ceiling thickness
- If required, replacement with frame construction on the underside adapt to the thickness of the finished ceiling

The clear dimensions of the completed, fire resistance compliant ceiling opening, together with the floor to ceiling height, provide the 4 order dimensions for the attic stairs.

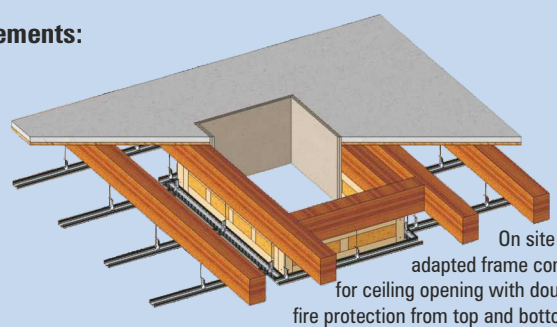

Attic stairs - what is important?

- Does the **old loft ladder** in the existing building meet **today's requirements**?
- What should be considered when **choosing attic stairs** for a new building?

Dangerous falling height!

Building regulations: Guardrail!

EN attic stairs regulations: Exit step at top end. Ceiling thickness!

EN attic stairs recommendation: Handrail!

EN attic stairs regulations: First step at base. Floor to ceiling height!





Install safely. And fast.

Installation box: Small box - big advantages

Wellhöfer attic stairs with thermal protection WS or fire protection FS are always supplied with the complete installation material. The tested ceiling connection systems for airtight / fire resistant execution of the installation joint are also included in the installation box. The QR codes on the installation guides lead directly to short video clips demonstrating the particular installation step.



Wellhöfer installation assistance:

This installation charger pays off.

The installation assistance **speeds up the installation of Wellhöfer attic stairs**. Makes exact alignment of the casing even faster and easier.

Pays for itself from the 5th attic stairs onward.



Safely ordering attic stairs: Always use all ④ dimensions!

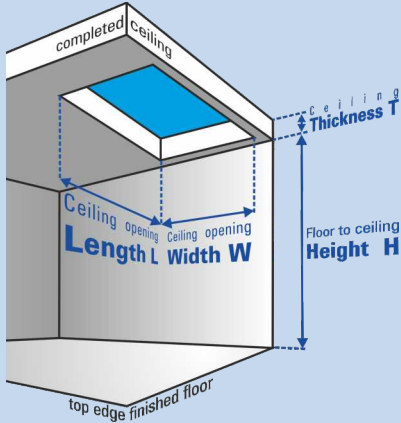

- **Ceiling opening Length L**
 - **Ceiling opening Width W**
 - **Ceiling Thickness (casing height) T**
(provides EN compliant additional step if required due to high casing)
 - **Floor to ceiling Height H**
(provides fitting stairs with EN compliant step distance)
- Do not forget:
- **Guardrail**
 - **Handrail**

Use the configurator:
www.massbox.de



Wellhöfer Bodentreppen Produktkonfigurator
MassBox - Immer die passende Bodentreppe
Weiter zurücksetzen | Hilfe | Videoanleitung | Katalog | Datenblatt | Preisliste

Maßangaben	Bodentreppe Typ	
Genauere Maße in Zentimeter angeben. Lichte Raumhöhe bestimmt Mindestlänge der Deckenöffnung	GutHolz Die dreiteilige Bodentreppe für alle Fälle	Alu Drei Die dreiteilige Aluminiumtreppe für höchste Belastbarkeit
Deckenöffnung Länge L [] cm		
Deckenöffnung Breite B [] cm	Bei aktuell gewählter Raumhöhe und Ausstattung mindestens nötig: - Deckenöffnung Länge: 110 cm - Platzbedarf: 166 cm	Bei aktuell gewählter Raumhöhe und Ausstattung mindestens nötig: - Deckenöffnung Länge: 113 cm - Platzbedarf: 167 cm
Deckenstärke Höhe H [] cm	Stahlblau Die dreiteilige Bodentreppe für besondere Ansprüche	Lilput Die Scherentreppe für viel Komfort bei wenig Platz
Lichte Raumhöhe R [] cm		
<input type="checkbox"/> Breite Deckleisten für maßgefertigte Bodentreppe Seriellmäßig bei Bodentreppe mit Wärmeschutz WSPN.	Bei aktuell gewählter Raumhöhe und Ausstattung mindestens nötig: - Deckenöffnung Länge: 109 cm - Platzbedarf: 162 cm	Bei aktuell gewählter Raumhöhe und Ausstattung mindestens nötig: - Deckenöffnung Länge: 80 cm - Platzbedarf: 110 cm

Dimension check, price calculation, pdf/text-copy-function.

Ceiling opening (length x width) and casing size

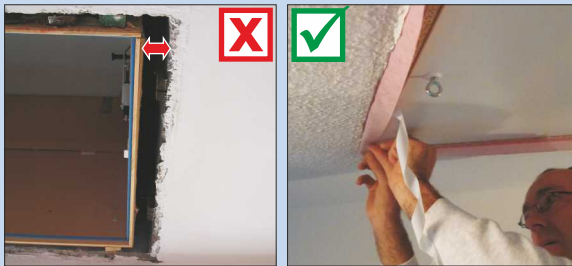

Length and width of the ceiling opening determine the order dimensions for the attic stairs. Then no adjustments need to be executed on site. **All fits:** Ceiling connection system, adjustment screws, cover profiles.

Ceiling opening dimensions = order dimensions. For installation space, factory-made casing dimensions are 1.5 cm (length/width) smaller.

Wellhöfer attic stairs are available for ceiling openings with lengths 75 - 160 cm and widths 50 - 100 cm.

Completed ceiling thickness and casing height

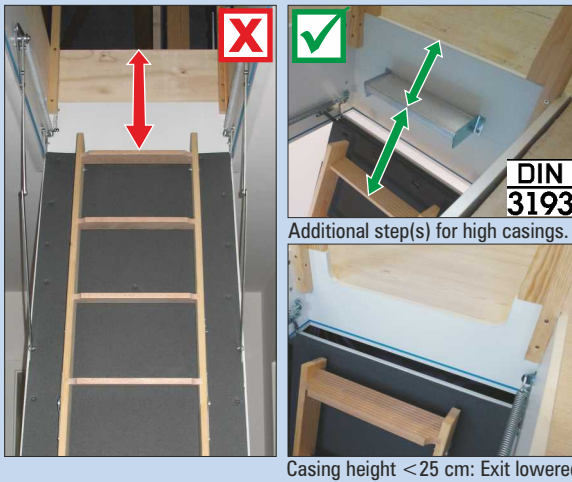

The ceiling thickness is another **important order specification!** Besides the visual aspect, it is mainly a matter of **user safety**. A too big distance between the top step and the loft floor is a **dangerous fall trap!** Depending on the ceiling thickness, if necessary, Wellhöfer installs EN compliant **additional step(s)** in high casings.

The correct height of the casing is also important for the prescribed **guardrail**. If the casing is lower than the ceiling thickness, the guardrail sits too low and does not reach the required 90 cm railing height!

Low casings therefore are only lowered at the exit to heights <25 cm.

Wellhöfer attic stairs are available for ceiling thicknesses 17 - 90 cm.

Floor to ceiling height and stair part

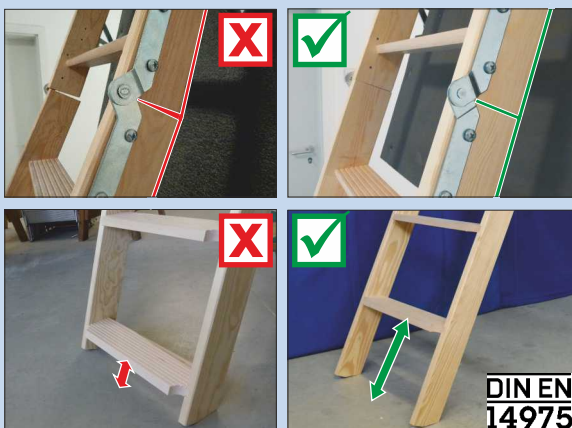

This is where most mistakes are made! Wooden stairs often have to be sawn down to match the existing floor to ceiling height. In addition, many stairs are adjusted incorrectly. Both aspects lead to **tripping hazards** and **endanger the long-term safety** of the stairs!

When ordered with the **actual existing floor to ceiling height**, Wellhöfer always provides the **fitting stairs with EN compliant step spacing**. No sawing needs to be done on site. **Floor to ceiling height, type of stairs and additional features determine the minimum length of the ceiling opening!**

Wellhöfer attic stairs are available for floor to ceiling heights 190 - 410 cm.

FLACHDACH AUSSTIEG

Flat roof exits



**CLIMATE NEUTRAL
PRODUCT**

certified by fokus-zukunft.com/10014
Currently unavoidable emissions compensated
by climate protection certificates

LOW-EMISSION PRODUCT
according to the criteria of



**SENTINEL HAUS
INSTITUT**

Proven, light, comfortable.

Flat roof exit for Wellhöfer attic stairs

FLACHDACH AUSSTIEG

- Easy installation without crane
- Integrated rear ventilation
- One-hand operation
- Special sizes for replacement of skylight domes



Flat roof exits

Measurement service and installation support

For commercial customers we offer a special service with the first Wellhöfer flat roof exit. For the measurement we go to the roof together with you. Also during the first time installation we will be on site to advise you.

Ask your Wellhöfer specialist dealer about our measurement service and installation support.

Dimensions in centimetres

Dimensions		Special sizes
Ceiling opening dimensions (Length x Width)	min. 90 x 60 max. 160 x 80	min. 90 x 90 max. 100 x 100
Construction height	45 - 110	
Floor to ceiling heights and type of stairs and add. features determine min. length of opening.		
Floor to ceiling height (min. - max.)	190 - 410*	

Order with all 4 dimensions

MassBox **Quick and error-free to the fitting flat roof exit.**

Use the configurator: www.massbox.de

Dimensions are construction side dimensions. Construction height > 45 cm: Attic stairs custom-made (casing height). Depending on the type of stairs and in combination with further additional features divergent dimensions may apply. Special sizes only possible in combination with concertina attic stairs Liliput. Ceiling opening dimensions = order dimensions. For installation space, factory-made casing dimensions are 1.5 cm (length/width) smaller.

* For floor to ceiling heights 320 cm and higher the concertina stair type Liliput always require the comfort operation for the stair section.

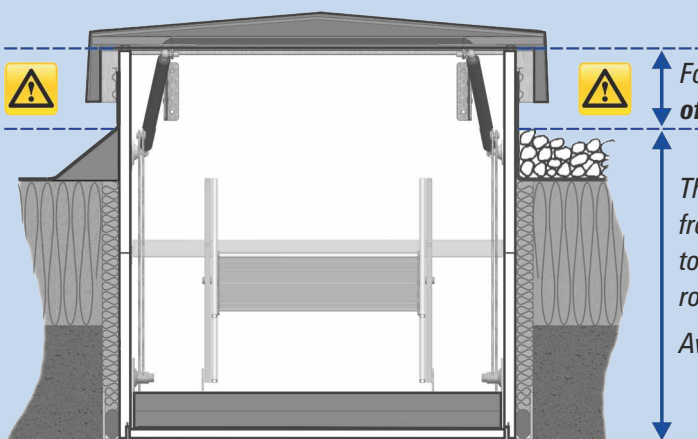

For fault-free opening and closing, a **roof overhang of 22 cm minimum** is always required.

The **construction height** is measured from the lower edge of the ready-made room ceiling to the upper edge of the finished roof (e.g. filling, green roof, wedge, ...).

Available for **construction heights 45 - 110 cm.**

Fig.: Concertina attic stairs Liliput with thermal protection WS4D and flat roof exit

KNIESTOCK TÜRE

Wall hatches



**CLIMATE NEUTRAL
PRODUCT**

certified by fokus-zukunft.com/10014
Currently unavoidable emissions compensated
by climate protection certificates

LOW-EMISSION PRODUCT
according to the criteria of



**SENTINEL HAUS
INSTITUT**

Create space. Gain storage room.

Wall hatch doors give access to the knee-storey behind the jamb wall



- Many possibilities of applications
- Different types can be combined
- From 30 x 30 to 100 x 180 cm (width x height)

Standard advantages

- **Tested low-emission product**
Significantly below the limit values of the Sentinel Haus Institute
- **Certified climate neutral product**
Currently unavoidable emissions compensated by climate protection certificates
- **Adjustable clip-on hinges**
Easy to remove/insert the door leaf when putting away bulky objects
- **Furniture quality**
White door surface with all-round ABS edge
- **Rounded mitred cover profiles**



Dimensions in centimetres

Standard sizes	
Wall opening dimensions (Width x Height)	60 x 80 60 x 100 70 x 80 70 x 100
Frame depth	10 (with WS 4D Standard depth: 15)
Custom-made	
Wall opening dimensions (Width x Height)	min. 30 x 30 max. 100* x 180
Frame depth	> 10 - 25

Individually to your needs:



Quick and error-free to the fitting wall hatch.
Use the configurator:
www.massbox.de

Dimensions are construction side dimensions in centimetres. Divergent dimensions may apply in combination with different types and additional features. Wall opening dimensions = order dimensions. For installation space, factory-made frame dimensions are 1.5 cm (width/height) smaller..
*For width > 70 cm always double-wing door.
For 3-sided type or large sizes (width > 90 cm or height > 160 cm), the frame is supplied as a plug-in system (transport protection).

Types and additional features

Energy conservation	Optic and types	Fire protection
<ul style="list-style-type: none"> ■ Thermal protection WS 3D U-value 0.75 Insulation+sealing+connection system ■ Thermal protection WS 4D U-value 0.50 Double insulation+sealing+connection system ■ Blower-Door-version 	<ul style="list-style-type: none"> ■ Wall-flush Invisible frame ■ PushLock-closure Retractable knob ■ Lock ■ Cabinet Dust-tight storage space ■ Double-wing door Divided door leaf ■ 3-sided type Without threshold ■ 5-cornered type Inclined 	<ul style="list-style-type: none"> ■ Fire protection FS30 2S Fire resistance 30 minutes double-sided tested
Page 22/23		

Wall hatches

Numerous types. Wide range of applications.



Double-wing door

Instead of a single door, the door-leaf of the double-wing type is divided vertically in the middle and fitted with a stop bar. Due to the divided door, it is always custom-made.

The double-wing type is possible from a width of 50 cm, from width >70 cm always necessary for technical reasons.



3-sided

For access to the knee-storey **without threshold**, the 3-sided type is available. The frame, which is open at the bottom, is assembled on site and placed on the floor. This creates a level passage.

Always specify right/left hand door.

Figure shows left hand door.



Cabinet

From a key cabinet to a **built-in cupboard** or as a bathroom module - **wall hatches with cabinet** offer dust-protected storage space. Especially as wall-flush type with PushLock-closure there are endless possibilities. The number of shelves can be selected up to 5.

Dimensions for wall hatches with cabinet		
Wall opening dimensions (Width x Height)	min. 20 x 45 max. 70 x 100	
Depth of cabinet	15 - 40	

Dimensions in centimetres. Wall opening dimensions = order dimensions. For installation space, factory-made frame dimensions are 1.5 cm (length/width) smaller.

Take advantage of the possibilities.

Simply create your individual wall hatch with the MassBox configurator

KNIESTOCK
TURE

Wall-flush

Often the door is installed in a stud wall and should be flush with the wall. There is a suitable solution: **wall-flush type**.

With a **thicker door leaf** and mitred **plastering profiles**, the flush with the wall installation succeeds and the result looks perfect.

Ideal for installation in plasterboard stud walls.



PushLock-closure

Instead of the standard handle knob or the version without a pre-drilled hole (to position and choose your own handle), the PushLock-closure is available as an option. The **retractable knob** locks the wall hatch airtight. When the button is pressed it jumps out and serves as a handle. Especially in combination with wall-flush type, the PushLock-closure is a nice extra (see photos).

Only for one-wing doors up to width max. 70 cm.



5-cornered

The angled design allows side access to the knee storey. Also under stairs the 5-cornered type is the suitable solution.

Dimensions for 5-cornered wall hatches in cm	
Wall opening dimensions (Width x Height)	min. 30 x 50 max. 70 x 160
Frame depth	10 - 15

Short width/height min. 20 cm each, sloping side min. 15 cm.
Wall opening dimensions = order dimensions. For installation space, frame dimensions are 1.5 cm (width/height) smaller.



DeckenTüre



Access hatches



**CLIMATE NEUTRAL
PRODUCT**

certified by fokus-zukunft.com/10014
Currently unavoidable emissions compensated
by climate protection certificates

LOW-EMISSION PRODUCT
according to the criteria of



**SENTINEL HAUS
INSTITUT**

For smallest openings

The professional solution

- For ceiling openings from **30 x 30 cm** to **75 x 70 cm** (Length x Width)
- **Maximum clearance** due to detachable door
- With thermal protection WS 3D/4D suitable for **Blower-Door-test**

Standard advantages

- **Tested low-emission product**
Significantly below the limit values of the Sentinel Haus Institute
- **Certified climate neutral product**
Currently unavoidable emissions compensated by climate protection certificates
- **Adjustable clip-on hinges**
Easy to remove/insert the door leaf for maximum clearance
- **Furniture quality**
White door surface with all-round ABS edge
- **Rounded mitred cover profiles**

DeckenTüre



Dimensions in centimetres

Standard sizes	
Ceiling opening dimensions (Length x Width)	50 x 50 60 x 60
Ceiling thickness = frame height	10 (with WS 4D Standard height: 15)
Custom-made	
Ceiling opening dimensions (Length x Width)	min. 30 x 30 max. 75 x 70
Ceiling thickness = frame height	> 10 - 25

Calculate clearance.



Quick and error-free to the fitting access hatch. Use the configurator: www.massbox.de

Dimensions are construction side dimensions in centimetres. Ceiling opening dimensions = order dimensions. For installation space, factory-made frame dimensions are 1.5 cm (length/width) smaller. **Clearance** is in width 5 cm and in length 8 cm (when door is unhinged) smaller than the ceiling opening.

Clearance comparison

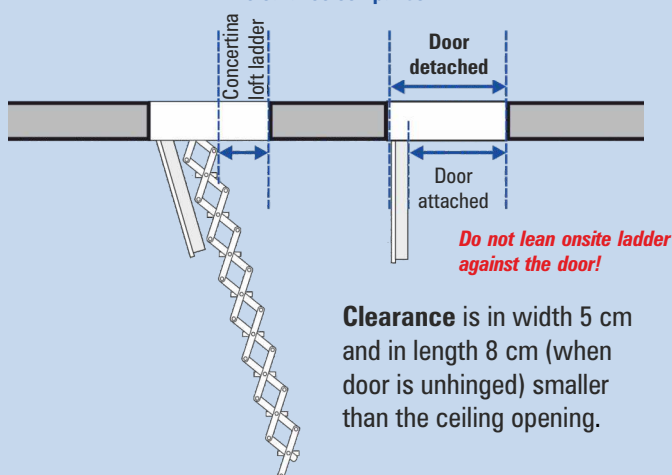

The opening in the ceiling is so small that even a concertina attic stairs no longer fits! A ladder can still be used, but how do you close the hole in the ceiling?

Wellhöfer access hatches are the professional solution.

Additional features

Energy conservation and safety

- **Thermal protection WS 3D** U-value 0.75
Insulation + sealing + connection system
- **Thermal protection WS 4D** U-value 0.50
Double insulation + sealing + connection system
- **Lock**

Beautiful space-saving stairs



midstep

Step shape straight
Wood type pine
Surface lacquered
Railing screwed on
Banisters with stakes



topstep

Step shape straight
Wood type beech
Surface lacquered
Railing flush with stringer
Railing with stainless steel rods

Wood types and surfaces*:
(shown with **topstep** curved step)



Craftsmanship in the smallest of spaces

* **midstep** only available in beech lacquered or pine lacquered.

Wood is a naturally grown material. Colour variations, dimensional tolerances, different grains and appearances characterise this individual material and do not represent a reduction in quality.

Large selection even with little space

topstep
midstep

Examples for **total going length**:

topstep, curved steps
midstep, straight steps

In addition to the total going length we recommend at least another 50 cm.

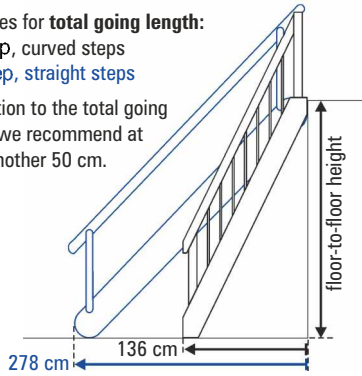

total going lengths	floor-to-floor height:	
	260 cm	280 cm
topstep , curved	136	146
topstep , straight	232	250
midstep , angled	162	124
midstep , straight	278	258



topstep with curved steps; handrail



Handrail side-flush / screwed to the outside

The available space decides.

Space-saving staircases provide the user with excellent space-saving advantages. If it is really tight instead of straight steps, curved or angled steps are also possible in order to require even less space (total going length).

Step shapes:



Pine, beech, oak; lacquered or oiled.

Even with little space, the staircase can be an eye-catcher. When selecting the solid glued wood, attention is paid to the correct fiber course. **Pine** is suitable for a rustic environment and has occasional knots. **Beech** is the knot-free staircase wood. **Oak** is considered a classic and is very stable and particularly durable.

Two-layer **water-based varnish** ensures a hard-wearing, glossy surface. Alternatively, double-layer **hard wax oiling** in white, natural, chocolate or black is available.

midstep is available in pine or beech lacquer. For **topstep** oak is available as a further type of wood and, in addition to lacquer, various oiled surfaces are also possible.

Traditional stairs construction: topstep

Stamped steps ensure a form-fitting connection. The **side-flush railing** guarantees high lateral stability. The railing rods (wood or stainless steel) are fixed in the stringer and positioned in the required safety distance. The ready-to-install **topstep** is **always custom-made** and is possible up to a floor-to-floor height of 325 cm. Extensive additional features, such as guardrails, gallery railings or opening cladding, ensure a safe and attractive finish.

Inexpensive alternative: midstep

The correct height (250 - 285 cm) is determined by the slope of the stringers. The steps are screwed in place according to the template. Posts and pales are screwed to the outside of the stringers and handrail.

Measurements:

Construction side dimensions in centimetres
Floor-to-floor height: topstep 200-325 / midstep 250-285
Ceiling opening Length: min. 110 / 120
Ceiling opening Width: min. 60

Wellhöfer - We stand up to our responsibilities

Stairs from Würzburg for more than 70 years

Health



Our products are often installed in residential buildings, attic stairs usually in the hallway between the bedroom and the children's room. Healthy living is a high priority for us. In emission tests, our products prove significantly below the strict limit values.

LOW-EMISSION PRODUCTS
according to the criteria of



**SENTINEL HAUS
INSTITUT**

Environment



We have been self-sufficient in heating for decades and cover our energy needs with photovoltaics. We are permanently working on CO₂ reduction. Currently unavoidable emissions are compensated with climate protection certificates.



**CLIMATE NEUTRAL
PRODUCTS**

certified by fokus-zukunft.com/10014
Currently unavoidable emissions compensated
by climate protection certificates

Social



WIR SIND TEIL DER

Stiftung
Julius-Spital
Würzburg

Julius-Spital



In 2011 we became part of the over 440 years old Julius-Spital Foundation. Since we joined, we have continuously and reliably supported this renowned foundation in its many social tasks (retirement home, hospice, clinic).

Gutfühlen mit Wellhöfer



wellhöfer
TREPPEN AUS WÜRZBURG
www.wellhoefer.de



Wellhöfer Treppen GmbH & Co.KG
Max-Mengeringhausen-Straße 1
97084 Würzburg, Germany

info@wellhoefer.de
Tel. +49 (0)9 31 / 6 14 05-0
Fax +49 (0)9 31 / 6 14 05 71